

Lorraine

CRUISING THE ALSACE REGION OF FRANCE

The Barge Connection
2036 Nevada City Highway #311
Grass Valley, CA 95945
Phone 888.550.8580
Phone 530.274.0764
Fax 530.274.0825
www.bargeconnection.com
Email info@bargeconnection.com

08/06/08



T H E B A R G E

C O N N E C T I O N

TECHNICAL SPECIFICATIONS

Lorraine

SPECIFICATIONS

Size: 128' X 17'

Capacity: 22

Crew: 7

Cabins: 11

Accommodations: 11 Twins

Heat & Air: Air Conditioning and Central Heat Provided

Cruising Region: Alsace

Length of Cruise: 6 Nights

Departure Day: Saturday

Meals: All Included

Beverages: Wines with Lunch & Dinner (open bar not included)

Entrance Fees: Included

Hairdryers: Supplied

Laundry Facilities: Not available

Paris Transfer: Strasbourg Rail Station

Pick-Up Time: 4:30 PM

Drop Off: Strasbourg Rail Station

Drop Off Time: 10:00 AM

Recreational Items: Bicycles, Small Library of books and games, Music System

BOAT DIAGRAM

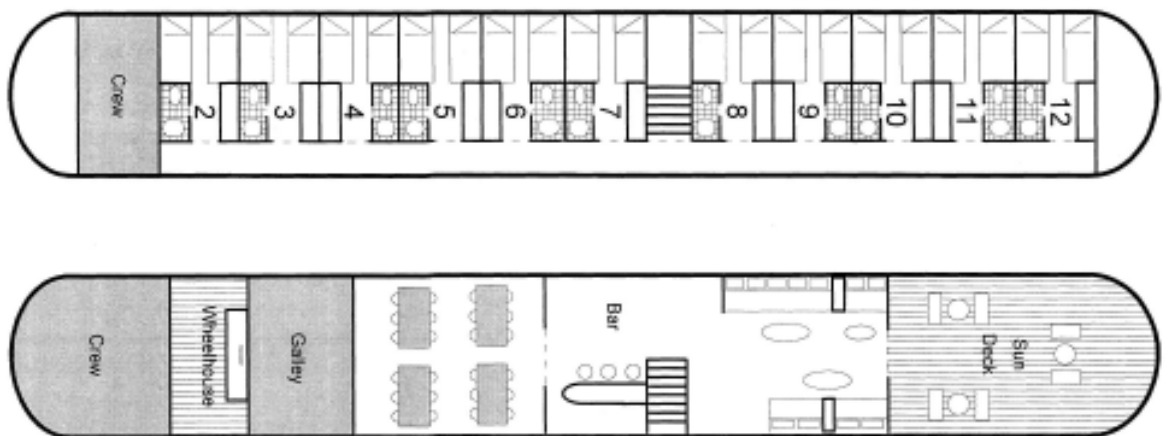

08/06/08

Phone: 888.550.8580
Phone: 530.274.0764



Email: info@bargeconnection.com
Website: www.bargeconnection.com

T H E B A R G E

C O N N E C T I O N

SAMPLE ITINERARY

Lorraine

ALSACE REGION
KRAFT TO XOUAXANGE

Saturday KRAFT

Transfer from the Strasbourg Rail Station at 4:30 PM and then escorted to the Lorraine, which will be moored in the village of **KRAFT**. Kraft is only twenty five kilometres to the South of Strasbourg, close to the junction of the canal with the river Rhine. The crew will welcome you aboard with “apéritifs” as the luggage is taken to the cabins and there will be time to settle in before dinner.

Sunday KRAFT/STRASBOURG

After breakfast we cruise on the Canal du Rhône au Rhin, a peaceful waterway that has seen little use since the building of the Grand Canal d’Alsace (the canalisation of the Rhine) in the nineteen-fifties. We moor during lunch and from here we take the coach to drive south to *Colmar for a guided tour of the city* centre with its magnificent medieval and Renaissance buildings, 13th century collegiate church and waterside “little Venice” area. Afterwards there will be free time to explore the city further, its shops and museums, particularly the *Unterlinden museum*, famous for its collection of Renaissance art works and specifically for the masterpiece of Mathias Grünewald, the Issenheim altarpiece. Towards the end of the afternoon we shall head back northwards along the “Route des Vins”, a small road running at the base of the foothills of the Vosges parallel to the Rhine through *the famous vineyards of Alsace*. We pass through several typical wine growing villages and make a short stop at the famous beauty spot of *Riquewihr for a visit to a cellar to taste some local vintages* before returning to the Lorraine now moored in Strasbourg.

Monday STRASBOURG/WALTENHEIM

Cast off early and cruise over breakfast and through the morning passing the European parliament. After lunch, disembark for a *guided walking tour of the principal sights of Strasbourg* including the picturesque “petite France” riverside district and the remarkable cathedral of Notre Dame whose construction spread over five centuries from the Romanesque choir to the flamboyant gothic spire. Afterwards there will be time free to explore the capital of Alsace, perhaps visit one of the museums, take advantage of the excellent shopping or just stroll through the cobbled streets of timbered houses before returning to the Lorraine at her mooring close by in the village of **Waltenheim sur Zorn**.

Tuesday WALTENHEIM/SAVERNE/LUTZELBOURG

We cast off after breakfast and cruise through the morning, passing several typical Alsatian villages. A number of locks and the recently restored towpath give excellent opportunities for walking alongside the boat or maybe cycling into one of the villages to appreciate the produce of a local brewery in a “Bierstub”. After lunch we moor in **Saverne**, an attractive, bustling town with a population of some ten thousand inhabitants. From our mooring we have an excellent view of the imposing red sandstone château built by the Rohan family during the

08/06/08

Phone: 888.550.8580
Phone: 530.274.0764



Email: info@bargeconnection.com
Website: www.bargeconnection.com

T H E B A R G E

C O N N E C T I O N

SAMPLE ITINERARY

Lorraine

ALSACE REGION
KRAFT TO XOUAXANGE

eighteenth century. After a stroll in the town, a visit to Haut-Barr a ruined chateau from the 11c with magnificent views of the plain of Alsace, then a delightful afternoon cruise into the picturesque small town of Lutzelbourg.

Wednesday LUTZELBOURG/HESSE

After breakfast we can make a short drive to visit a crystal workshop and see how some of the most famous products of this area are still individually fashioned by hand. We join the boat a few kilometres further on and cruise over the border into Lorraine where the canal follows the steep-sided, tree-lined valley of the river Zorn to the famous *inclined plane of Arzwiller*. Here a ladder of seventeen locks has been replaced by a counterbalanced barge lift that hauls us up nearly 150 feet to the summit level of the Marne to Rhine canal. We then cruise through a cutting and two tunnels under the peak of the Vosges Mountains before mooring for the evening at a quiet spot near the village of **Hesse**.

Thursday HESSE/XOUAXANGE

After breakfast we continue to cruise along the summit pound, or highest section, of the Marne to Rhine canal. This section of some thirty kilometres with no locks passes through the regional park of Lorraine, an officially recognised nature reserve with numerous lakes and vast areas of woodland. The canal then begins its descent towards the plain of Lorraine through a series of locks, the first of which was built in the nineteen-fifties to replace a flight of seven of the original early nineteenth century locks and has a drop of nearly fifty feet. After lunch we take the coach for a drive to Sarrebourg and visit the chapel of the Cordelieres where we can see the stained glass window created by Marc Chagall. We return to Lorraine, moored in Xouaxange for our farewell gala dinner.

Friday Leave the Lorraine after breakfast and transfer to Strasbourg Rail Station at 10:00 AM.

PLEASE NOTE: THIS IS A SAMPLE ITINERARY AND IS SUBJECT TO CHANGE. ON ALTERNATE WEEKS CRUISES WILL BE IN REVERSE DIRECTION.

08/06/08

Phone: 888.550.8580
Phone: 530.274.0764



Email: info@bargeconnection.com
Website: www.bargeconnection.com

T H E B A R G E

C O N N E C T I O N

2009 PRICES

Lorraine

Per Person

Low Season: **\$2,805 US**
1700 Euros
High Season: **\$3,135 US**
1900 Euros

Charter

Low Season: **\$56,100 US**
34,000 Euros
High Season: **\$62,700 US**
38,000 Euros

Single Supplement

\$742 US
450 Euros

LOW SEASON DEPARTURE DATES

March 21 to April 25, July 11 to August 15, October 24 to November 7

HIGH SEASON DEPARTURE DATES

May 2 to July 4. August 22 to October 17

**The US rate may change due to exchange fluctuations.
Please contact us for a current US rate.**

08/06/08

Phone: 888.550.8580
Phone: 530.274.0764



Email: info@bargeconnection.com
Website: www.bargeconnection.com

T H E B A R G E

C O N N E C T I O N

2009 CRUISE SCHEDULE

Lorraine

March 7	Kraft to Xouaxange
March 14	Xouaxange to Kraft
March 21	Kraft to Xouaxange
Mar 28	Xouaxange to Kraft
Apr 4	Kraft to Xouaxange
Apr 11	Xouaxange to Kraft
Apr 18	Kraft to Xouaxange
Apr 25	Xouaxange to Kraft
May 2	Kraft to Xouaxange
May 9	Xouaxange to Kraft
May 16	Kraft to Xouaxange
May 23	Xouaxange to Kraft
May 30	Kraft to Xouaxange
Jun 6	Xouaxange to Kraft
Jun 13	Kraft to Xouaxange
Jun 20	Xouaxange to Kraft
Jun 27	Kraft to Xouaxange
Jul 4	Xouaxange to Kraft
Jul 11	Kraft to Xouaxange
Jul 18	Xouaxange to Kraft
Jul 25	Kraft to Xouaxange
Aug 1	Xouaxange to Kraft
Aug 8	Kraft to Xouaxange
Aug 15	Xouaxange to Kraft

08/06/08

Phone: 888.550.8580
Phone: 530.274.0764



Email: info@bargeconnection.com
Website: www.bargeconnection.com

T H E B A R G E

C O N N E C T I O N

2009 CRUISE SCHEDULE

Lorraine

Aug 22	Kraft to Xouaxange
Aug 29	Xouaxange to Kraft
Sept 5	Kraft to Xouaxange
Sept 12	Xouaxange to Kraft
Sept 19	Kraft to Xouaxange
Sept 26	Xouaxange to Kraft
Oct 3	Kraft to Xouaxange
Oct 10	Xouaxange to Kraft
Oct 17	To Be Advised
Oct 24	To Be Advised
Oct 31	To Be Advised

08/06/08

Phone: 888.550.8580
Phone: 530.274.0764



Email: info@bargeconnection.com
Website: www.bargeconnection.com

T H E B A R G E

C O N N E C T I O N

SAMPLE MENU

Lorraine

SAMPLE LUNCH MENU

Tarte à l'Oignon et Fromage
Salade de Pommes de Terre 'Bistrot'
Salade de Tomates et Feta

Salade d'Epinars ou Mâche

Mousse au Chocolat

SAMPLE DINNER MENU

Cassolette d'Escargot Bressane à la Crème d'Ail

Volaille au Cidre

Salad and Two Cheeses

Fraises Ecrasées au Croustillant de Riz au Lait

Coffee

08/06/08

Phone: 888.550.8580
Phone: 530.274.0764



Email: info@bargeconnection.com
Website: www.bargeconnection.com

T H E B A R G E

C O N N E C T I O N