

# Libellule

CRUISING THE BURGUNDY REGION FRANCE

The Barge Connection  
2036 Nevada City Highway #311  
Grass Valley, CA 95945  
Phone 888.550.8580  
Phone 530.274.0764  
Fax 530.748.0101  
[www.bargeconnection.com](http://www.bargeconnection.com)  
Email [info@bargeconnection.com](mailto:info@bargeconnection.com)

08/06/08



T H E   B A R G E

C O N N E C T I O N

## TECHNICAL SPECIFICATIONS

# Libellule

### SPECIFICATIONS

Size:	128' X 17'
Capacity:	20
Crew:	7
Cabins:	10
Accommodations:	6 Twins, 1 Double (upper deck), 2 Twins, 1 Double (lower deck)
Heat & Air:	Central Heat and Air
Cruising Region:	Burgundy
Length of Cruise:	6 Nights
Departure Day:	Saturday
Meals:	All Included
Beverages:	Wines with lunch and dinner (open bar not included)
Entrance Fees:	All Included
Hairdryers:	Supplied
Pick-Up Location:	Dijon Rail Station - in the station yard near the Transco Motorcoach bus stop <b>Number 17</b>
Pick-Up Time:	4:30 PM
Drop Off:	Dijon Rail Station
Drop Off Time:	10:00 AM
Recreational Items:	Bicycles, library of books and games, sound system
Cruising Season:	April to November

### BOAT DIAGRAM

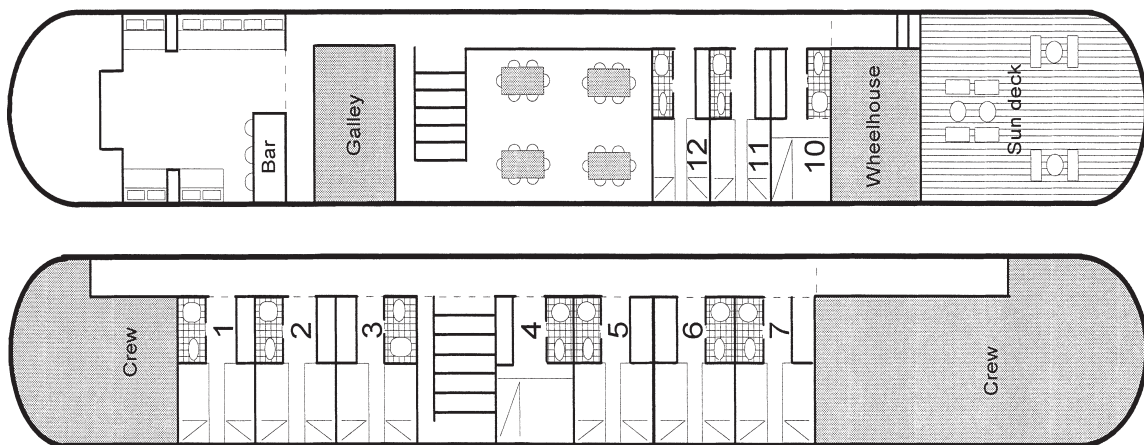

08/06/08

Phone: 888.550.8580  
Phone: 530.274.0764



Email: [info@bargeconnection.com](mailto:info@bargeconnection.com)  
Website: [www.bargeconnection.com](http://www.bargeconnection.com)

T H E B A R G E

C O N N E C T I O N

## 2009 SAMPLE ITINERARY

# Libellule

DIJON TO ST LEGER SU DHEUNE  
CANAL DE BOURGOGNE, SAONE RIVER AND CANAL DU CENTRE

### Saturday - Dijon

You will be met at the Dijon Rail Station. From here you will be transferred to the Libellule, which will be moored in the Port of Dijon close to the city centre, where we stay for the night. The crew will serve a welcome cocktail as the bags are taken to the cabins, after which there will be time to settle in or walk into town before dinner is served on board.

### Sunday - Dijon / Longecourt en Plaine

Disembark after breakfast to drive through the vineyards of the Côte de Nuits for a guided visit of the château of Clos Vougeot, medieval monastic winery and present-day headquarters of the Confrérie des Chevaliers du Tastevin. Return to Libellule in time for lunch at a lock just outside Dijon and cruise through the afternoon. Good opportunities to walk along the towpath or to cycle into nearby villages between the fairly frequent locks this afternoon before we moor at the village of Longecourt en Plaine.

### Monday - Longecourt en Plaine / St Jean de Losne / Seurre

Cast off during breakfast. Morning cruise to St Jean de Losne, traditionally the centre of barging in Burgundy and situated at the junction of the Canal de Bourgogne with the river Saône. After lunch coach excursion to Beaune, the centre of the Burgundy wine trade, for a guided visit of the Hôtel Dieu, world famous charity hospital which was founded in the fifteenth century and is a masterpiece of late-medieval architecture. Free time to visit the town with its wine museum, magnificent Romanesque church and wine cellars. Return to Libellule at Seurre, charming brick-built riverside town.

### Tuesday - Seurre / Chalon sur Saône

Today is market day in Dijon, so after an early breakfast we drive there for a guided tour of the principal sights of the city centre followed by time free to explore the market and the excellent shopping centre. Return to Libellule in Seurre for lunch and cruise through the afternoon down the Saône river to our mooring for tonight, Chalon sur Saône, second largest city in Burgundy and important trading centre since Gallo-Roman times. Time to visit the beautifully preserved medieval town centre surrounding the Cathedral of St Vincent before dinner.

08/06/08

Phone: 888.550.8580  
Phone: 530.274.0764



Email: [info@bargeconnection.com](mailto:info@bargeconnection.com)  
Website: [www.bargeconnection.com](http://www.bargeconnection.com)

T H E B A R G E

C O N N E C T I O N

## 2009 SAMPLE ITINERARY

# Libellule

DIJON TO ST LEGER SU DHEUNE  
CANAL DE BOURGOGNE, SAONE RIVER AND CANAL DU CENTRE

### Wednesday - Chalon sur Saône / Chagny

We cast off from our mooring in Chalon during breakfast; however there will be an opportunity to stay in town to visit the excellent shops or the Niecephore Niepce museum, inventor of photography and native of Chalon. We enter the Canal du Centre from the river through a lock with a fifty-foot rise and cruise along an attractive winding stretch, with good opportunities to walk or cycle along the green cycling track recently built along the Canal du Centre between Chalon and St Léger. Towards the end of the afternoon we make an excursion to the nearby village of Rully for a guided tour of the twelfth century château. Return to Libellule at our mooring for tonight in the lively little town of Chagny.

### Thursday - Chagny / Santenay / Dennevy / St Léger sur Dheune

Cruise through the morning to Santenay and moor in time to explore this famous wine-producing village of the Côte de Beaune before lunch. Wine tasting. Cruise over lunch and through the afternoon to St Léger for our gala dinner. Good cycling and walking all day on the restored towpath.

### Friday - St Léger sur Dheune

After an early breakfast, you will be transferred to the Dijon Rail Station at approximately 10:00 AM.

Note that this is a sample itinerary: it is subject to modification in the case of unforeseen circumstances and canal closures. Please check our web site for latest update on our detailed itinerary. We cruise in opposite direction on alternate weeks.

08/06/08

Phone: 888.550.8580  
Phone: 530.274.0764



Email: [info@bargeconnection.com](mailto:info@bargeconnection.com)  
Website: [www.bargeconnection.com](http://www.bargeconnection.com)

T H E B A R G E

C O N N E C T I O N

2009 PRICES

# Libellule

## Per Person

Low Season: **\$2,805 US**  
1700 Euros  
High Season: **\$3,135 US**  
1900 Euros

## Charter

Low Season: **\$53,460 US**  
32,400 Euros  
High Season: **\$59,400 US**  
36,000 Euros

## Single Supplement

\$742.00 US  
450 Euros

## Upper Deck Per Person Supplement

**\$495 US**  
300 Euros

### LOW SEASON DEPARTURE DATES

March 21 to April 25, July 11 to August 15, October 24 to November 7

### HIGH SEASON DEPARTURE DATES

May 2 to July 4. August 22 to October 17

**The US rate may change due to exchange fluctuations.  
Please contact us for a current US rate.**

08/06/08

Phone: 888.550.8580  
Phone: 530.274.0764



Email: [info@bargeconnection.com](mailto:info@bargeconnection.com)  
Website: [www.bargeconnection.com](http://www.bargeconnection.com)

T H E B A R G E

C O N N E C T I O N

## 2009 CRUISE SCHEDULE

# Libellule

March 7	St Leger to St Jean de Losne
March 14	St Jean de Losne to St Leger
March 21	St Leger to St Jean de Losne
Mar 28	St Jean de Losne to St Leger
Apr 4	St Leger to St Jean de Losne
Apr 11	St Jean de Losne to St Leger
Apr 18	St Leger to St Jean de Losne
Apr 25	St Jean de Losne to St Leger
May 2	St Leger to St Jean de Losne
May 9	St Jean de Losne to St Leger
May 16	St Leger to St Jean de Losne
May 23	St Jean de Losne to St Leger
May 30	St Leger to St Jean de Losne
Jun 6	St Jean de Losne to St Leger
Jun 13	St Leger to St Jean de Losne
Jun 20	St Jean de Losne to St Leger
Jun 27	St Leger to St Jean de Losne
Jul 4	St Jean de Losne to St Leger
Jul 11	St Leger to St Jean de Losne
Jul 18	St Jean de Losne to St Leger
Jul 25	St Leger to St Jean de Losne
Aug 1	St Jean de Losne to St Leger
Aug 8	St Leger to St Jean de Losne
Aug 15	St Jean de Losne to St Leger
Aug 22	St Leger to St Jean de Losne

08/06/08

Phone: 888.550.8580  
Phone: 530.274.0764



Email: [info@bargeconnection.com](mailto:info@bargeconnection.com)  
Website: [www.bargeconnection.com](http://www.bargeconnection.com)

T H E B A R G E

C O N N E C T I O N

## 2009 CRUISE SCHEDULE

# Libellule

Aug 22	St Leger to St Jean de Losne
Aug 29	St Jean de Losne to St Leger
Sept 5	St Leger to St Jean de Losne
Sept 12	Dijon to Vandenesse
Sept 19	Vandenesse to Dijon
Sept 26	St Jean de Losne to St Leger
Oct 3	St Leger to St Jean de Losne
Oct 10	St Jean de Losne to St Leger
Oct 17	St Leger to St Jean de Losne
Oct 24	St Jean de Losne to St Leger
Oct 31	St Leger to St Jean de Losne

08/06/08

Phone: 888.550.8580  
Phone: 530.274.0764



Email: [info@bargeconnection.com](mailto:info@bargeconnection.com)  
Website: [www.bargeconnection.com](http://www.bargeconnection.com)

T H E   B A R G E

C O N N E C T I O N

SAMPLE MENU

# Libellule

**SAMPLE LUNCH MENU**

Tarte à l'Oignon et Fromage  
Salade de Pommes de Terre 'Bistrot'  
Salade de Tomates et Feta

\*\*\*

Salade d'Epinars ou Mâche

\*\*\*

Mousse au Chocolat

**SAMPLE DINNER MENU**

Cassolette d'Escargot Bressane à la Crème d'Ail

\*\*\*

Volaille au Cidre

\*\*\*

Salad and Two Cheeses

\*\*\*

Fraises Ecrasées au Croustillant de Riz au Lait

\*\*\*

Coffee

08/06/08

Phone: 888.550.8580  
Phone: 530.274.0764



Email: [info@bargeconnection.com](mailto:info@bargeconnection.com)  
Website: [www.bargeconnection.com](http://www.bargeconnection.com)

T H E B A R G E

C O N N E C T I O N