

Impressionniste

CRUISING THE OUCHE VALLEY IN THE BURGUNDY REGION

The Barge Connection
2036 Nevada City Highway #311
Grass Valley, CA 95945
Phone 888.550.8580
Phone 530.274.0764
Fax 530.274.0825
www.bargeconnection.com
Email info@bargeconnection.com

08/06/08



T H E B A R G E

C O N N E C T I O N

TECHNICAL SPECIFICATIONS

Impressionniste

SPECIFICATIONS

Size:	128X16'6"
Capacity:	12
Crew:	5
Cabins:	6
Accommodations:	1 Double, 2 Twins and 3 Twin/Doubles & 1 Single
Heat & Air:	Central Heat & Air Conditioning
Cruising Region:	Provence & Camargue
Length of Cruise:	6 Nights
Departure Day:	Sunday
Electricity:	3 X 220 volt generators (silent night running)
Engine:	150 HP Debutz, maximum speed 10 knots
Water:	20 tons of water and 3 tons of fuel
Meals:	All Included
Beverages:	All Included
Entrance Fees:	All Included
Hairdryers:	Supplied
Laundry Facilities:	Not available
Transportation:	Transfers to and from Montpellier or Avignon, motorcoach for excursions
Pick-Up Location:	Montpellier Metropole Hotel, rue Clos Rene 3, 34000 Montpellier
Pick-Up Time:	4:00 PM
Pick-Up Location:	Avignon Grand Hotel, 34 Boulevard Saint Roche, 84000 Avignon
Pick-Up Time:	4:00 PM
Recreational Items:	12 Mountain bikes, Jacuzzi, library and sound system with CD
Cruising Season:	April until November

BOAT DIAGRAM

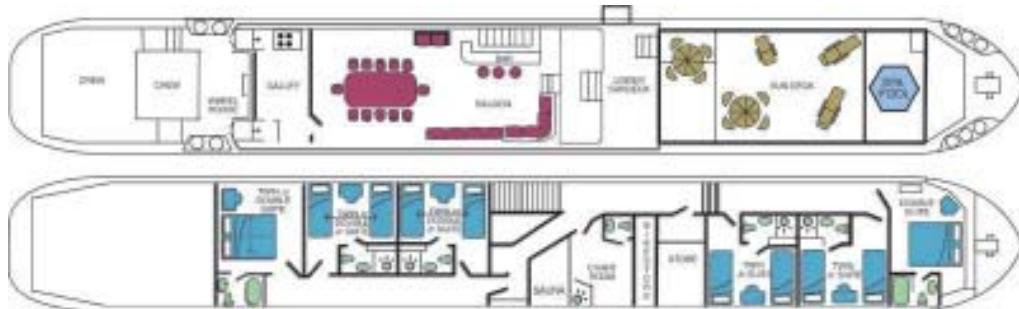

08/06/08

Phone: 888.550.8580
Phone: 530.274.0764



Email: info@bargeconnection.com
Website: www.bargeconnection.com

T H E B A R G E

C O N N E C T I O N

SAMPLE ITINERARY

Impressionniste

BURGUNDY OUCHE VALLY 2009

DIJON TO ESCOMMES

Sunday – Dijon

You are met at the meeting hotel at 4.30pm and transferred to the elegant L'Impressionniste moored in the Port of Dijon for your cruise through Burgundy. A Champagne reception welcomes you on board and provides you with a chance to meet the crew. Enjoy a stroll into Dijon before Dinner aboard.

Monday – Dijon to Fleurey sur Ouche

This morning experience your first day's cruise along this enchanting canal, which also promises a walk or cycle along an ever present towpath, as we ascend gradually to the canal summit, past sleepy villages and pretty lock houses. Leaving Dijon, we pass Lake Kir and cruise by the limestone escarpments, which feed the nearby vineyards. After lunch we visit **Clos de Vougeot**, headquarters of the esteemed **Chevaliers du Tastevin**, who award every year a special prized label to the finest Cote d 'Or vintages. We offer a private tasting of Vosne Romanee, Gevrey Chambertin, Cote de Nuits and Nuits-St-Georges at the family run **Domaine Jafflin** in the heart of Nuits-St-Georges on the route des Grands Crus. Our excellent relationship with the Jafflin family goes back over 20 years. Dinner aboard.

Tuesday – Fleurey sur Ouche to Gisse sur Ouche

After breakfast, enjoy a walking tour of old **Dijon** including a visit to the vivid flower and produce market, **mustard shops** and the flamboyant 14th century **Ducal Palace** (or enjoy some excellent shopping time). Return to the boat for lunch and leisurely afternoon cruise to Gisse sur Ouche. Dinner aboard.

Wednesday – Gisse sur Ouche to La Bussiere

This morning we visit the moat - encircled 13th century **Chateau de Commarin**. Going back 26 generations, the de Vogue family ownership portrays an insight into the glamorous lives of French aristocracy as well as showing off the Chateau, stables and landscaped gardens. After lunch we cruise to La Bussiere, passing grazing white Charolais cattle, rolling hills and picturesque villages. Dinner aboard.

08/06/08

Phone: 888.550.8580
Phone: 530.274.0764



Email: info@bargeconnection.com
Website: www.bargeconnection.com

T H E B A R G E

C O N N E C T I O N

SAMPLE ITINERARY

Impressionniste

BURGUNDY OUCHE VALLY 2009

DIJON TO ESCOMMES

Thursday - La Bussiere to Crugey

Early morning cruise and exclusive tour of the magnificent 12th century Abbaye de la Bussiere. The ornamental gardens and lake, wine press, crypt and cellars are interwoven with ancient colonnades, stone staircases and huge stained glass windows. After a **Kir Royale** aperitif in the private music room, the former chapel, we enjoy the gastronomic delights of Master Chef Olivier Elzer in the vaulted Michelin starred restaurant whilst enjoying the sommelier's choice of local burgundies. This afternoon we continue to the mediaeval village, craft shops and castle of **Chateauneuf-en-Auxois**, once an outpost of the Dukes of Burgundy and offering a fine overview of the feeder lakes, canal and surrounding country side. Dinner aboard.

Friday - Crugey to Escommes

Our last day's leisurely cruise takes us to the canal summit, 1250 feet above sea level, just before the Pouilly tunnel. In the afternoon we cross the premier cru vineyards into Beaune, capital of Burgundy wine country with a history going back over 2000 years. We absorb the fascinating 15th century **Hotel Dieu Hospice** and visit Maison Champy, Beaune's oldest winery established in 1720 with even older cellars. Captain's Farewell Dinner aboard

Saturday - Dijon

After breakfast disembark the barge and transfer to Dijon station by 9.00. (suggested train to Paris TGV 6710 departing Dijon at 9.57 and arrive in Paris, Gare de Lyon at 11.37am).

Itinerary is subject to change. On alternative weeks, the cruise is in reverse direction.

08/06/08

Phone: 888.550.8580
Phone: 530.274.0764



Email: info@bargeconnection.com
Website: www.bargeconnection.com

T H E B A R G E

C O N N E C T I O N

2009 PRICES

Impressionniste

	VALUE	REGULAR
Junior Suite Per Person	\$4,350	\$4,990
Senior Suite Per Person	\$4,590	\$5,290
Single Supplement	\$1,700	\$1,900
Charter for 10 guests	\$46,900	\$54,500
Charter for 11 guests	\$48,200	\$56,000
Charter for 12 guests	\$49,500	\$57,500
Charter for 13 guests	\$50,800	\$59,000

VALUE SEASON DATES: March 29, April 5, 12, 19, 26; May 3, 10, July 26, August 2, 9, 16, 23; October 18, 25; November 1, 8

REGULAR SEASON DATES: May 17, 24, 31; June 07, 14, 17, 21, 28; July 05, 12, 19; Sept 06, 13, 20, 27; October 04, 11

Golf Charter: \$400 per golfer supplement for individuals or \$4,000 per charter - available for charter groups or minimum 4 golfers booked on a cabin basis

Wine Charter: \$3,000 per charter supplement - available for charter groups only

(The supplement includes the services of a Professional Wine Guide and an upgrade to the wine list on board, to include some Premier and Grand Cru Wines)

Family Charter: \$300 discount offered to children aged 0-17

Charter groups only

08/06/08

Phone: 888.550.8580
Phone: 530.274.0764



Email: info@bargeconnection.com
Website: www.bargeconnection.com

T H E B A R G E

C O N N E C T I O N

SAMPLE MENU

Impressionniste

Regional Specialities

Filet d'Agneau au Basilic

Magret de Canard

Poulet à L'Estragon

Wine cellar

Chablis

Vosne Romanée

Domaine Laroche,

Nuit St-Georges

Epineuil

Cheese board

Aisy Cendré

Bouton de Culotte

Epoisses

Ami du Chambertin

08/06/08

Phone: 888.550.8580
Phone: 530.274.0764



Email: info@bargeconnection.com
Website: www.bargeconnection.com

T H E B A R G E

C O N N E C T I O N