

# *Impressionniste*

CRUISING THE PROVENCE AND CAMARGUE REGIONS OF SOUTHERN FRANCE

The Barge Connection  
2036 Nevada City Highway #311  
Grass Valley, CA 95945  
Phone 888.550.8580  
Phone 530.274.0764  
Fax 530.274.0825  
[www.bargeconnection.com](http://www.bargeconnection.com)  
Email [info@bargeconnection.com](mailto:info@bargeconnection.com)



THE BARGE

CONNECTION

# TECHNICAL SPECIFICATIONS

## *Impressionniste*

### SPECIFICATIONS

---

Size:	128X16'6"
Capacity:	12
Crew:	5
Cabins:	6
Accommodations:	1 Double, 2 Twins and 3 Twin/Doubles & 1 Single
Heat & Air:	Central Heat & Air Conditioning
Cruising Region:	Provence & Camargue
Length of Cruise:	6 Nights
Departure Day:	Sunday
Electricity:	3 X 220 volt generators (silent night running)
Engine:	150 HP Debutz, maximum speed 10 knots
Water:	20 tons of water and 3 tons of fuel
Meals:	All Included
Beverages:	All Included
Entrance Fees:	All Included
Hairdryers:	Supplied
Laundry Facilities:	Not available
Transportation:	Transfers to and from Montpellier or Avignon, motorcoach for excursions
Pick-Up Location:	Montpellier Metropole Hotel, rue Clos Rene 3, 34000 Montpellier
Pick-Up Time:	4:00 PM
Pick-Up Location:	Avignon Grand Hotel, 34 Boulevard Saint Roche, 84000 Avignon
Pick-Up Time:	4:00 PM
Recreational Items:	12 Mountain bikes, Jacuzzi, library and sound system with CD
Theme Cruises:	Art, Wine & Golf
Cruising Season:	April until November

### BOAT DIAGRAM

---

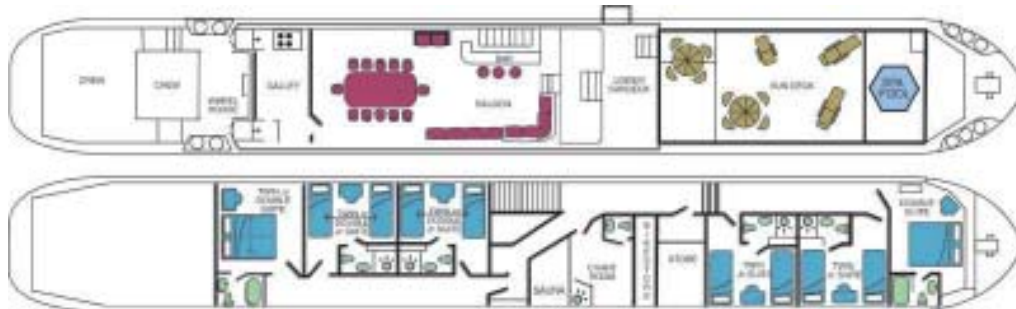

Phone: 888.550.8580  
Phone: 530.274.0764



Email: [info@bargeconnection.com](mailto:info@bargeconnection.com)  
Website: [www.bargeconnection.com](http://www.bargeconnection.com)

T H E B A R G E

C O N N E C T I O N

## SAMPLE ITINERARY

# *Impressionniste*

AVIGNON TO AGDE

### **Sunday**

You will be met at 16.00 at Montpellier Metropole Hotel in Montpellier and escorted by minibus to the L'Impressionniste for a Champagne Welcome. Spend the night onboard in Avignon.

### **Monday, Avignon to Arles**

This morning we visit the Palais des Papes, a massive monument to the era of the 'OtherRome', when the popes moved to France. After a stroll through the vibrant shopping district of Avignon, return to the barge for lunch. In the afternoon we cruise down the mighty Rhone River to Arles, passing the immense citadel of King René at Tarascon, and the foothills of the Alpilles.

### **Tuesday, Arles to Aigues Mortes**

This morning we explore Arles, the Roman Arena, St. Trophime's Basilica and the Museum of Provençal life. We visit some of Vincent Van Gogh's haunts on foot through the pedestrianized heart of this old capital of the Camargue. Then cruise down the Petit Rhone and on to the Canal de Rhone a Sete, passing several herds of wild Black bulls. We moor at Aigues Mortes.

### **Wednesday, Aigues Mortes to Frontignan**

Stroll from our mooring outside the town walls to visit the Tour de Constance, built in 1248 as a lighthouse and since used as a prison. Then in the afternoon we cruise the Canal du Rhone à Sete through the Camargue National Park with its wild horses, black bulls and pink flamingoes, to the hamlet of Les Aresquières where we are 200 yards from the Mediterranean.

### **Thursday, Frontignan to Marseillan**

An early start to pass under the lifting Bridge at Frontignan, then we sail out onto the Etang de Thau, a large, inland, salt water lake. Mid-morning we stop briefly at Bouzigues to visit the Museum of the lake with its exhibition on oyster culture, which is the main activity of the many local fishermen. After lunch on board, we have a short minibus ride to the 12thC Abbaye de Valmagne with its vast Cistercian church and beautiful cloister. Our tour ends with a chance to taste its award winning range of wines. Returning to the barge, we have an afternoon cruise on the lake to the port of Marseillan, where we stroll into the marketplace for dinner ashore. This gives you a chance to taste many of the local seafood delicacies.

Phone: 888.550.8580  
Phone: 530.274.0764



Email: [info@bargeconnection.com](mailto:info@bargeconnection.com)  
Website: [www.bargeconnection.com](http://www.bargeconnection.com)

T H E B A R G E C O N N E C T I O N

## SAMPLE ITINERARY

# *Impressionniste*

AVIGNON TO AGDE

### **Friday, Marseillan to Agde**

Before the ship sails we have an opportunity to tour the cellars and distillery of the world famous aperitif, Noilly Prat, followed by a tasting. Then an afternoon cruise on the Canal du Midi, through the renowned round lock and finishing our voyage on the River Herault. We will be moored in the shadow of the Cathedral of the fishing town of Agde, built of lava blocks from the nearby volcano. Captains dinner on board.

### **Saturday**

Return transfer by minibus a Beziers or Montpellier's TGV Station, Montpellier Airport or Montpellier's Metropole Hotel.

Sample itinerary and is subject to change

Phone: 888.550.8580  
Phone: 530.274.0764



Email: [info@bargeconnection.com](mailto:info@bargeconnection.com)  
Website: [www.bargeconnection.com](http://www.bargeconnection.com)

T H E B A R G E

C O N N E C T I O N

## SAMPLE ITINERARY

# *Impressionniste*

GOLF CRUISE

### Sunday - Golf cruise

Day 1 - Avignon You will be met at 16.00 at a pre-arranged hotel in Avignon and escorted by minibus to the L'Impressionniste for a Champagne Welcome. Spend the night onboard in Avignon.

### Monday - Golf cruise

Day 2 - Avignon to Arles

This morning we transfer to GOLF DU GRAN AVIGNON (6037m, Par 72). This 18 hole golf course, 15 miles from Avignon was built 10 years ago and was designed by M Roumeas. Return to the barge for lunch. In the afternoon we cruise down the mighty Rhone River to Arles, passing the immense citadel of King René at Tarascon, and the foothills of the Alpilles

### Tuesday - Golf cruise

Day 3 - Arles to Aigues Mortes

This morning we transfer to GOLF DE LA GRAND MOTTE. (6161m, Par 72) 18 hole golf course on the edge of Lank Ponant. The seaside resort of Grand-Motte is famous for its pyramids, offers you two courses, one 18 hole and one 6 hole, both designed in the pure traditional Florida style by landscape designer Robert Trent Jones Senior. Return to the barge for lunch before a cruise down the Petit Rhone and on to the Canal de Rhone a Sete, passing several herds of wild Black bulls. We moor at Aigues Mortes

### Wednesday - Golf cruise

Day 4 - Aigues Mortes to Frontignan

This morning we transfer to GOLF DE FONTCAUDE (6250m Par 72) 18 hole course designed by Chris Pittman and laid out in 1991. This international course is very varied, being laid out in the fragrant garrigue and along the banks of the wooded river. Then in the afternoon we cruise the Canal du Rhone à Sete through the Camargue National Park with its wild horses, black bulls and pink flamingoes, to the hamlet of Les Aresquiers where we are 200 yards from the Mediterranean

### Thursday - Golf cruise

Day 5 - Frontignan to Marseillan

An early start to pass under the lifting Bridge at Frontignan, then we sail out onto the Etang de Thau, a large, inland, salt water lake. Mid-morning we stop briefly at Bouzigues to visit the Museum of the lake with its exhibition on oyster culture, which is the main activity of the many local fishermen. After lunch on board, we transfer to GOLF DE SAINT THOMAS (6130m, Par 72) This 18 hole golf course was designed by Patrice Lambert and laid out in

Phone: 888.550.8580  
Phone: 530.274.0764



Email: [info@bargeconnection.com](mailto:info@bargeconnection.com)  
Website: [www.bargeconnection.com](http://www.bargeconnection.com)

T H E B A R G E

C O N N E C T I O N

## SAMPLE ITINERARY

# *Impressionniste*

GOLF CRUISE

1993. It is set in typically Mediterranean scenery in the still wild garrigue. It has its own particular personality to interest all levels of players, from the beginner to the very experienced. Woods and hills, with stretches of water and other more classical fairways. We stay the night in the port of Marseillan, where we stroll into the marketplace for dinner ashore. This gives you a chance to taste many of the local seafood delicacies

### **Friday - Golf cruise**

Day 6 - Marseillan to Agde

Morning golf at GOLF DU CAL D'AGDE (6279m Par 72) 18 hole golf course in colourful landscape, Ronald Fream, one of the worlds greatest designers, has created a particularly inventive course. You will never forget the greens, jealously guarded by the bunkers. Then an afternoon cruise on the Canal du Midi, through the renowned round lock and finishing our voyage on the River Herault. We will be moored in the shadow of the Cathedral of the fishing town of Agde, built of lava blocks from the nearby volcano. Captains dinner on board

### **Saturday - Golf cruise**

Day 7 - Agde

Return transfer by minibus to Agde TGV train Station or other location to be advised prior to booking.

Phone: 888.550.8580  
Phone: 530.274.0764



Email: [info@bargeconnection.com](mailto:info@bargeconnection.com)  
Website: [www.bargeconnection.com](http://www.bargeconnection.com)

T H E B A R G E

C O N N E C T I O N

## SAMPLE ITINERARY

# *Impressionniste*

ART CRUISE

### **Sunday, Art cruise Day 1 - AVIGNON**

You will be met at 16.00 at Montpellier Metropole Hotel in Montpellier and escorted by minibus to the L'Impressionniste for a Champagne Welcome. Spend the night onboard in Avignon.

### **Monday, Art cruise Day 2 - AVIGNON TO ARLES**

This morning we cruise down the mighty Rhone River to Arles, passing the intriguing citadel of King René at Tarascon, and the foothills of the Alpilles. Introductory talk on Cezanne, Van Gogh and the lifestyle of the Impressionists before lunch on board. In the afternoon, instruction ashore in painting and drawing. Dinner on board.

### **Tuesday, Art cruise Day 3 - ARLES TO AIGUES MORTES**

This morning we explore Arles, with a guided tour of the Roman Arena, St. Trophime's Basilica and the Museum of Provençal life. We visit some of Vincent Van Gogh's haunts on foot, where he painted so many of his beloved scenes, through the pedestrianized heart of this old capital of the Camargue.

Partake in a session of sketching instruction on the banks of the Rhône. We then a cruise down the Petit Rhone and on to the Canal de Rhone a Sete, passing several herds of wild black bulls. We moor at the medieval fortified town of Aigues Mortes. Dinner on board.

### **Wednesday, Art cruise Day 4 - AIGUES MORTES TO FRONTIGNAN**

Stroll from our mooring outside the town walls of Aiges Morte with a FULL DAY of art instruction in the medieval town built by Louis IX. Visit the Tour de Constance, built in 1248 as a lighthouse for the returning 13th century Crusaders. Late afternoon, we cruise the Canal du Rhône à Sete through the Camargue National Park with its wild horses, abundant sea bird life and flocks of pink flamingoes, to the hamlet of Les Aresquiers where we are 200 yards from the Mediterranean. Dinner on board.

### **Thursday, Art cruise Day 5 - FRONTIGNAN TO MARSEILLAN**

An early start to pass under the lifting Bridge at Frontignan, then we sail out onto the Etang de Thau, a large, inland, salt water lagoon full of oyster beds. Mid-morning we stop briefly at Bouzigues to visit the Museum of the lake with its exhibition on oyster culture, which is the main activity of the many local fishermen. Lunch on board.

This afternoon we spend painting and sketching at the 12th Century Abbaye de Valmagne with its vast Cistercian church and beautiful cloister. Our day ends with a chance to taste its award winning range of wines. Returning to the barge, we have a late afternoon cruise on the lake to the port of Marseillan, where we stroll into the marketplace for dinner ashore. This gives you a chance to taste many of the local seafood delicacies.

Phone: 888.550.8580  
Phone: 530.274.0764



Email: [info@bargeconnection.com](mailto:info@bargeconnection.com)  
Website: [www.bargeconnection.com](http://www.bargeconnection.com)

T H E B A R G E

C O N N E C T I O N

## SAMPLE ITINERARY

# *Impressionniste*

ART CRUISE

**Friday, Art cruise Day 6 - MARSEILLAN TO AGDE**

A short ride in the minibus this morning for a FULL DAY of art instruction in the shadows of the Cathedral of the fishing town of Agde, built of lava blocks from the nearby Black Mountains.

L'Impressionniste will meet us in the port of Agde late afternoon for the Gala Farewell Dinner

**Saturday, Art cruise Day 7 - AGDE**

Return transfer by minibus to Beziers or Montpellier's TGV Station, Montpellier Airport or Montpellier's Metropole Hotel.

This is a sample itinerary. Alternative weeks the cruise will be in reverse direction

Phone: 888.550.8580  
Phone: 530.274.0764



Email: [info@bargeconnection.com](mailto:info@bargeconnection.com)  
Website: [www.bargeconnection.com](http://www.bargeconnection.com)

T H E B A R G E

C O N N E C T I O N

## 2008 PRICES

# *Impressionniste*

	VALUE	REGULAR
Junior Suite Per Person	\$3,990	\$4,590
Senior Suite Per Person	\$4,250	\$4,850
Single Supplement	\$1,550	\$1,750
Charter for 10 guests	\$43,200	\$49,500
Charter for 11 guests	\$44,500	\$51,000
Charter for 12 guests	\$45,800	\$52,500
Charter for 13 guests	\$47,100	\$54,000

**VALUE SEASON DATES:** March 23, 30; April 6, 13, 20; July 6, 13, 20, 27; August 3, 10, 17, 24; October 26; November 2

**REGULAR SEASON DATES:** April 27; May 4, 11, 18, 25; June 1, 8, 15, 22, 29; August 31; September 7, 14, 21, 28; October 5, 12, 19

A child reduction of \$300 is applicable for all children aged 0-17 years

**TRANS-EUROPE CRUISE:**

November 9

Phone: 888.550.8580  
Phone: 530.274.0764



Email: [info@bargeconnection.com](mailto:info@bargeconnection.com)  
Website: [www.bargeconnection.com](http://www.bargeconnection.com)

THE BARGE

CONNECTION

## TERMS & CONDITIONS

# *Impressionniste*

### INDIVIDUAL BOOKINGS:

- \$750 per person upon booking
- Balance due 60 days prior to departure

### CHARTER BOOKINGS

- A deposit of \$4,000 due upon booking
- 25% second deposit due 180 days prior to departure
- Balance due 120 days prior to departure

### CANCELLATIONS PER PERSON:

- More than 4 months prior to departure and when you have paid your deposit we will deduct \$350 per person administrative fee
- From 4-2 months prior to departure – full deposit retained
- When you have paid the full fare – from 2-1 months prior to departure – 80% of total fare is forfeited
- 1 month prior to departure to day of departure, or failure to embark - 100% of total fare is retained

Cancellation refunds will only be made upon return of cruise tickets and written cancellation. Allow 3-4 weeks after this for delivery of refunds. Credit for any deposit or other sums received will be given against the above and any balance refunded. No refunds will be made in the event of interruption of cancellation by the passenger after the start of travel

### CANCELLATIONS FOR CHARTERS:

- Deposits are non-refundable
- Up to 120 days prior to departure, deposits may be applied towards individual bookings on the same barge
- Less than 120 days prior to departure, no refund
- Changes of any kind will be subject to a \$150 surcharge per person. No refund for unused portions of packages or cruise

All cancellations must be made in writing and sent to the Barge Connection  
Travel cancellation insurance is highly recommended

Phone: 888.550.8580  
Phone: 530.274.0764



Email: [info@bargeconnection.com](mailto:info@bargeconnection.com)  
Website: [www.bargeconnection.com](http://www.bargeconnection.com)

T H E B A R G E

C O N N E C T I O N