

L'Etoile

CRUISING THE BURGUNDY REGION OF FRANCE

The Barge Connection
2036 Nevada City Highway #311
Grass Valley, CA 95945
Phone 888.550.8580
Phone 530.274.0764
Fax 530.274.0825
www.bargeconnection.com
Email info@bargeconnection.com



THE BARGE CONNECTION

TECHNICAL SPECIFICATIONS

L'Etoile

SPECIFICATIONS

Size:	111"X15.8"
Capacity:	7
Crew:	2
Cabins:	3
Accommodations:	2 Kings, 1 Double & 1 Single
Heat & Air:	Central Heat & Air Conditioning
Cruising Region:	Burgundy
Length of Cruise:	6 Nights
Departure Day:	Sunday
Meals:	All Included
Beverages:	All Included
Entrance Fees:	All Included
Hairdryers:	Supplied
Laundry Facilities:	Not available
Transportation:	Private Motorcoach for excursions
Pick-Up Location:	Central location near mooring
Pick-Up Time:	4:00 PM
Recreational Items:	6 bicycles (adult and children bikes available), a razor-scooter, fishing rods, satellite TV, a VCR, home entertainment system and e-mail facilities
Theme Cruises:	Barge & Bike, Barge & Wine, Barge & Shopping, Barge & Culinary
Cruising Season:	April until November

BOAT DIAGRAM

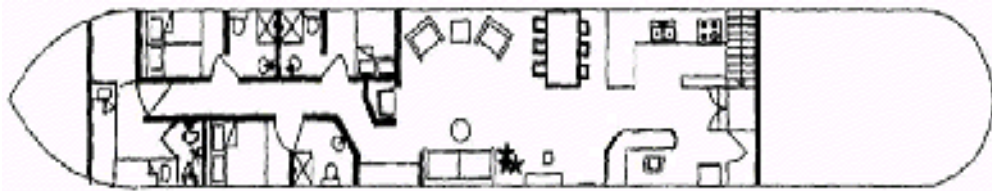

Phone: 888.550.8580
Phone: 530.274.0764



Email: info@bargeconnection.com
Website: www.bargeconnection.com

THE BARGE CONNECTION

SAMPLE ITINERARY

L'Etoile

BURGUNDY CRUISE
DOLE TO LE CREUSOT

Sunday

You will be met at the location of your choice in Dole, which is easily accessible by TGV train from Paris or as a rental car return point. You will be transferred to your charming barge home, moored in Dole, a flower-filled town built on a hill overlooking the River Doubs. A champagne welcome will be followed by your first evening meal on the barge.

Monday:

Cruise from Dole to Saint Jean de Losne. This morning you will go on a walking tour of Dole, the birth place of Louis Pasteur. His home, now a museum, is within walking distance. We return to the barge for lunch and in the afternoon we cruise down the canal du Rhone au Rhin towards Saint Symphorien. Passing the last lock of this canal, we enter the wide and spacious river Saone and cruise to Saint-Jean de Losne, where we will moor for the night. The charming little town is on walking distance.

Tuesday:

Cruise from Saint Jean de Losne to Seurre. In the morning we continue our cruise to Seurre, from where we depart with the minibus to visit Beaune, the wine capital of Burgundy. The 15th century Hospice (hospital) is one of the most fascinating sites in Burgundy. Then it is wine tasting at the famous Marché aux Vins, if you wish, you can buy wine here, these experts will ship your purchases back home safely. We return to the barge where dinner awaits us.

Wednesday:

Cruise from Seurre to Chalon sur Saone. We start our day cruising to Chalon sur Saone. Chalon is the birthplace of photography. In 1822 Nicéphore Niepce managed to capture an image on glass, there will be time to visit the photographic museum, right opposite our mooring. This afternoon you are free to browse in the picturesque shopping area or to relax in a café on the town square. Dinner will be served on the barge.

Thursday:

We leave Chalon in the morning, cruising up to the entrance of the canal du Centre, the first lock is over 50 feet high! We moor in Fragnes, a tranquil mooring and have lunch. The afternoon we go for a tour in the Burgundy wine country, followed by wine tasting in the chateau of Meursault. The chateau has been tastefully restored and today is one of the biggest and most beautiful estates in Burgundy.

Friday:

This morning we continue our leisurely cruise to Chagny. We pass thirteen locks, mostly on a short distance, now is a good time to take a walk on the towpath or explore the countryside by

Phone: 888.550.8580
Phone: 530.274.0764



Email: info@bargeconnection.com
Website: www.bargeconnection.com

T H E B A R G E C O N N E C T I O N

SAMPLE ITINERARY

L'Etoile

BURGUNDY CRUISE
DOLE TO LE CREUSOT

bicycle! After lunch we go for a tour in the minivan to the medieval château, La Rochepot - entered through a drawbridge! Then it's a stop at the ancient market place in Nolay to have a drink on the town square, or to browse in the antique shops. Our last on board dinner rounds out a wonderful day!

Saturday: You'll say "Au Revoir" and depart after breakfast for transfer to Le Creusot TGV Station. You may also be transferred to the airport, rental car office, or hotel of your choice.

Our sightseeing schedule is flexible and can be customized to reflect your interests.

Phone: 888.550.8580
Phone: 530.274.0764



Email: info@bargeconnection.com
Website: www.bargeconnection.com

THE BARGE CONNECTION

SAMPLE ITINERARY

L'Etoile

PROVENCE
AVIGNON TO MONTPELLIER

Sunday:

Pickup in Avignon, transfer to Beaucaire. Your party will be met at one location of your choice in Avignon, which is easily accessible by TGV train from Paris or as a rental car return point. Transfer to your charming barge home, moored in the nearby port of Beaucaire, known for its 15th century castle. Cobie will welcome you aboard with a champagne toast and the first of many gourmet dinners.

Monday:

A full day of sightseeing! Whole day out in fabulous Provence! You'll tour the Palais du Pape in Avignon, with free time to shop and stroll in this sophisticated town, followed by a visit to the Roman aqueduct Pont du Gard. Then its on to wine tasting at Chateauneuf de Pape. Lunch will be taken in a local auberge while dinner is back on your cozy barge home, still moored in Beaucaire.

Tuesday:

Beaucaire to St. Gilles. We can't leave Provence without visiting the enchanting hilltop village of Les Beaux, known for gorgeous views over the Provencal landscape, followed by shopping in charming St. Remy, home to Princess Caroline of Monaco and other celebrities. Then it's back to the barge for lunch and the beginning of our cruise! Float on the Canal du Rhone et Sete through the stunningly beautiful Camargue National Park, to the mooring in St Gilles. Dinner on board rounds out a wonderful day.

Wednesday:

St. Giles to Aigues Mortes. A morning cruise brings you to a mooring right at the gates of the amazing 13th century walled town of Aigues Mortes, an embarkation port for the Crusades. Mathias will introduce the many historical sites and then there will be time to climb the walls, shop for souvenirs, or relax in one of the many outdoor cafes. Dinner is on board.

Thursday:

Aigues Mortes to the Mediterranean. We'll cruise this morning to one of the most remarkable moorings in all of barging: at the 6th-century Maquelone Abbey on a peninsula with the Canal on one side and the Mediterranean on the other! Here there is much to experience – from a tour of this special abbey to an afternoon at the beach to observing the wild horses of the Camargue. (Horseback riding on the beach can also be arranged for an additional charge.) Dinner on board in view of the Mediterranean will be memorable.

Phone: 888.550.8580
Phone: 530.274.0764



Email: info@bargeconnection.com
Website: www.bargeconnection.com

T H E B A R G E C O N N E C T I O N

SAMPLE ITINERARY

L'Etoile

PROVENCE
AVIGNON TO MONTPELLIER

Friday:

From the Mediterranean inland to Frontignan. After a morning cruise to Frontignan, known for its sweet Muscat aperitif wine, we'll take a picnic lunch and spend the rest of the day exploring: whitewashed stone fishing villages perched on the Etang du Thau; a visit to an oyster farm (you can select and buy oysters to be served at dinner, if you wish!); and wine tasting in Frontignan. Arrive back to your barge in time for a festive Farewell Dinner.

Saturday:

Depart to Montpellier. You'll say "farewell" and depart after breakfast between 9:00 a.m. and 10:00 a.m. for transfer to Montpellier. There is, at present, a TGV train departure to Paris and a departure to Nice. You may also be transferred to the airport, rental car office, or hotel. We hope to welcome you back again!

This itinerary runs on opposite weeks in reverse between Fronignan/Montpellier and Avignon. Our sightseeing schedule is flexible and can be customized to reflect your interests. Occasionally an itinerary will be changed due to canal closures or inclement weather. The Captain will substitute an equally interesting route. Change in itinerary will not be accepted as cause for canceling your cruise.

Phone: 888.550.8580
Phone: 530.274.0764



Email: info@bargeconnection.com
Website: www.bargeconnection.com

THE BARGE CONNECTION

SAMPLE ITINERARY

L'Étoile

CANAL DU MIDI
MONTPELLIER TO BEZIERS

Sunday:

You will be met at the location of your choice in Montpellier and transferred to your comfortable barge home, moored in right at the heart of the "Petite Camargue" at the gates of the amazing 13th-century walled town of Aigues-Mortes, an embarkation port for the Crusades. You will be welcomed aboard with a champagne toast and the first of many gourmet dinners.

Monday:

This morning there will be time to climb the walls, shop for souvenirs, or relax in one of the many outdoor cafes in Aigues-Mortes. (Horseback riding on the can also be arranged for an additional charge.) After lunch we will cruise to the most peaceful and romantic mooring of the cruise - at the 6th-century Maguelone Cathedral on a peninsula with the Canal on one side and the Mediterranean Sea on the other! Dinner on board in view of the Mediterranean will surely be memorable.

Tuesday:

After a morning walk or bike ride to the Cathedral, observing flamingoes and other wildlife, or lounging at the beach, we will cruise in the afternoon close to Frontignan, known for its sweet and natural white apéritif wine. This evening you will dine in one of our favorite local restaurants.

Wednesday:

This morning our excursion is to the town of Sete, France's largest Mediterranean fishing town where you can enjoy watching its picturesque fishing boats and yachts maneuver through the old port. We will tour the open-air market and if you are up to the challenge, climb Mont St-Clair for a great view of the city, its canals, and the sea. We will cruise this afternoon on the Etang de Thau, alongside the oyster beds lined all the way to the entrance of the Canal du Midi. Dinner is on board.

Thursday:

Enjoy a morning cruise to Agde. We will pass the famous round lock of Agde, built by Pierre-Paul Riquet, who masterminded this whole construction. Our mooring is right in the city. History is waiting for you, we can visit the museum Agatois, walk or bike through this ancient town founded by the Phoenicians 2500 years ago. Discover 'Les Halles', the covered market or go for excellent shopping. A stop is possible at the Chateau of Picpoul de Pinet to taste this delicious white apéritif wine. Dinner is on board.

Phone: 888.550.8580
Phone: 530.274.0764



Email: info@bargeconnection.com
Website: www.bargeconnection.com

THE BARGE CONNECTION

SAMPLE ITINERARY

L'Etoile

CANAL DU MIDI
MONTPELLIER TO BEZIERS

Friday:

Today we will enjoy a morning cruise to the town of Beziars, perched on a hill at the foot of which the river Orb and the Canal du Midi sprawl. A visit to the 13th century fortified Cathedral of Saint Nazaire, with its commanding view across Pyrenees Mountains will prove to be one of the high points of your trip. Later we can explore the English-style garden, Le Plateau des Poètes, the 19th century market halls or the Museum of Fine Arts. Dinner is on board.

Saturday:

After breakfast, we will return you Montepellier. High-speed trains to the Paris/Gare de Lyon depart from here. We will anxiously await your return!

Phone: 888.550.8580
Phone: 530.274.0764



Email: info@bargeconnection.com
Website: www.bargeconnection.com

THE BARGE CONNECTION

2008 PRICES

L'Étoile

6 Night Cruises:

Sunday Departures

FULL BOARD:

Queen Cabin Per Person : \$2,900

King Cabin Per Person: \$3,200

Single Cabin: \$2,950

Single Supplement for King: \$1,000

Charter: \$18,000 (up to 6)

Charter: \$19,500 (up to 7)

Wine Cruise Charter: \$20,000 (up to 6)

Dine Around Gourmet Cruise: \$20,000 (up to 6)

HALF BOARD:

Charter \$16,000 (up to 6)

\$300 discount per child under 12 accompanied by an adult

Half Board Cruise:

the crew will help you to choose special restaurants for your evening meals (at your own cost) and provide transportation to and from your place of dining.

Full Board Cruise:

4 course evening meals are served aboard L'Étoile and on one evening you are invited to dine off the boat at a specially selected restaurant. Wine and drinks taken at the restaurant are included in the full board price. Note – entrance fees to places visited are not included in the Etoile charter prices.

Phone: 888.550.8580
Phone: 530.274.0764



Email: info@bargeconnection.com
Website: www.bargeconnection.com

THE BARGE CONNECTION

2008 CRUISE SCHEDULE

L'Etoile

	6-Apr	Montpellier - Avignon
Value	13-Apr	Avignon - Montpellier
Season	20-Apr	Montpellier - Avignon
	27-Apr	Avignon - Montpellier
	4-May	Montpellier - Avignon
	11-May	Avignon - Montpellier
Main	18-May	Montpellier - Avignon
Season	25-May	Avignon
	1-Jun	Beziers
	08-Jun	Beziers - Montpellier
	15-Jun	Montpellier - Avignon
	22-Jun	Avignon - Montpellier
	29-Jun	Montpellier - Avignon
	6-Jul	Avignon - Valence
	13-Jul	Valence - Lyon
	20-Jul	Lyon - Chalon
Value	27-Jul	Chalon - Creusot
Season	3-Aug	Creusot - Creusot
	10-Aug	Creusot - Creusot
	17-Aug	Creusot - Creusot
	24-Aug	Creusot - Creusot
	31-Aug	Creusot - Creusot
	7-Sep	Creusot - Creusot
Main	14-Sep	Creusot - Creusot
Season	21-Sep	Creusot - Creusot
	28-Sep	Saone - Rhone - Avignon
	5-Oct	Avignon - Montpellier
	12-Oct	Montpellier - Avignon
	19-Oct	Avignon - Montpellier
	26-Oct	Montpellier - Avignon

Phone: 888.550.8580
Phone: 530.274.0764



Email: info@bargeconnection.com
Website: www.bargeconnection.com

THE BARGE CONNECTION

MENU TYPES

L'Etoile

Sample Lunch Menu

Quiche Lorraine

Minestrone Soup

Mixed Green Salad with walnuts & Roquefort

Rosette, Smoked Ham, Sliced Duck,

Cheeses:

Beaufort, Conté, Brébis, Chaource,

Chèvre, Brie, Fourme, St. Agur

Epoisses, Camembert

Sample Dinner Menu

Salad Gourmande Au Foie Fras

Pate on a Bed of Crisp Greens served with Toast Points

Poularde a L'Ancienne Avec Sauce au Vinaigere

Traditionally Prepared Chicken in a Delicate Wine Vinegar Sauce Served
with Sauteed Patatoes and Fresh Seasonal Vegetables

Sorbet Citron

Phone: 888.550.8580
Phone: 530.274.0764



Email: info@bargeconnection.com
Website: www.bargeconnection.com

THE BARGE CONNECTION

MENU TYPES

L'Etoile

Our goal is to give you a real taste of France, serving wines from many different regions (but admittedly the Burgundy wines are our favorites!). It will be a pleasure to share our knowledge with you. We will teach you about the wine growing areas, winemaking, and how to read a French wine label.

Throughout your trip we will introduce you to our carefully selected local wines and premier cru wines. (If you don't know what that is, don't worry - we'll teach you!)

Some of the fine wines included in our cellar are:

Chassagne-Montrachet

Mercurey

Moulin à Vent

Gigondas

Faugères

Sancerre

Meursault Premier Cru

Pouilly-Fuissé

Lirac

Muscat sec de Frontignan

Phone: 888.550.8580
Phone: 530.274.0764



Email: info@bargeconnection.com
Website: www.bargeconnection.com

THE BARGE CONNECTION

TERMS & CONDITIONS

L'Etoile

INDIVIDUAL & CHARTER BOOKINGS:

- 30% deposit on either charter or cabin cost
- Balance due 90 days prior to departure
- Bookings made within 90 days of departure must be paid in full at the initial booking

CANCELLATIONS:

- Cancellations made more than 16 weeks in advance of the charter start date receive a full refund of monies paid, less \$150 per person cancellation fee
- Cancellations made 8-16 weeks in advance of charter start date receive all monies paid, less the 30% deposit
- Cancellations made less than 8 weeks prior to charter start date receive no refund
- To prevent needless hardship in case of emergency cancellation, we strongly recommend purchasing cancellation insurance at the time of initial payment

Unforeseen circumstances, such as weather, flood; drought, strikes and canal closures, means that occasionally the cruise route and or the excursions must be changed. We are not responsible for these occurrences. A change in a route or excursions cannot be acceptable as a cause for cancellation of a tour. An alternative and acceptable tour / excursions will be chosen.

The owners and booking agents assume no responsibility for a guests illness, injury or death while aboard the vessel, in the domain or its vehicle. Insurance against personal accident and loss of personal effects is not included in the charter price and no responsibility can be accepted for such accidents or losses. Guests are strongly advised to insure themselves and their belongings.

All cancellations must be made in writing and sent to the Barge Connection
Travel cancellation insurance is highly recommended

Phone: 888.550.8580
Phone: 530.274.0764



Email: info@bargeconnection.com
Website: www.bargeconnection.com

THE BARGE CONNECTION