

La Chouette

CRUISING THE NORMANDY REGION OF FRANCE

The Barge Connection
12036 Nevada City Highway #311
Grass Valley, CA 95945
Phone 888.550.8580
Phone 530.274.0764
Fax 530.274.0825
www.bargeconnection.com
Email info@bargeconnection.com



THE BARGE

CONNECTION

TECHNICAL SPECIFICATIONS

La Chouette

SPECIFICATIONS

Size:	100"X16'6"
Capacity:	6
Crew:	4
Cabins:	3
Accommodations:	3 Twin/Doubles
Heat & Air:	Central Heating & Air-Conditioning
Cruising Region:	River Seine / Normandy Region
Cruising Routes:	Belgium, Burgundy, Champagne & Normandy
Length of Cruise:	6 Nights
Departure Day:	Thursday
Engine:	Gardner 6L3B
Electricity:	220 volts AC
Meals:	All Included
Beverages:	All Included
Entrance Fees:	All Included
Hairdryers:	Supplied
Laundry Facilities:	Not available
Transportation:	Transfers from Paris hotel or Rouen Rail Station & Private Motorcoach for excursions
Pick-Up Location:	Paris hotel of your choice or Rouen Rail Station (depending on the direction of the cruise)
Pick-Up Time:	2:00 PM
Recreational Items:	6 Bikes, Library of books & games, fax & email
Cruising Season:	May 15 & 22 / Belgium Cruise May 29 to June 26 / France (Burgundy, Champagne or Normandy) August 28 to September 25 / France (Burgundy, Champagne or Normandy)
Special Note:	Short 3 & 4 Night B&B Cruises Available Upon Request (Charter Only)

BOAT DIAGRAM

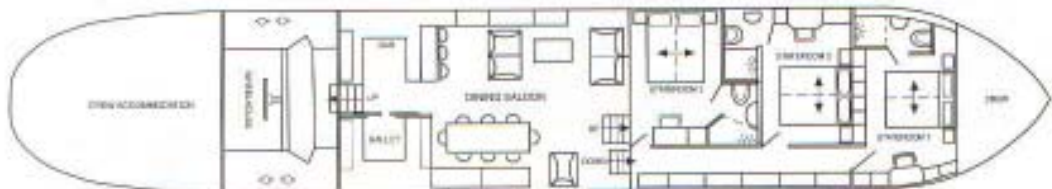

Phone: 888.550.8580
Phone: 530.274.0764



Email: info@bargeconnection.com
Website: www.bargeconnection.com

SAMPLE ITINERARY

La Chouette

NORMANDY
MAINLY MONET CRUISE

From the magnificent city of Paris follow the River Seine towards Rouen, famed capital of Normandy, where Monet painted the cathedral in so many different lights and moods. The following is a suggested itinerary only. Alternatives may be made according to guests' wishes and availability. The following is a suggested itinerary only.

Thursday

Your captain will meet you at your Paris hôtel. You will be escorted to La Chouette waiting for you at a nearby quay on the river Seine. Soon you will be cruising through the city of Paris, sipping champagne and soaking in the wonderful atmosphere. As we head out of Paris we pass Asnières and Argenteuil, names immortalised by the Impressionist painters like Monet and Renoir. Our mooring for tonight is at the very place these famous artists would meet for rest and relaxation. Maison Fournaise at Chatou was their favourite restaurant. And this is where you will enjoy your first evening meal of the cruise.

Friday

Breakfast is a relaxed affair on board La Chouette. Waken to the aroma of fresh coffee and croissants warming. A short early morning cruise takes us to La Grenouillère (The Froggery!) It was here that Monet and Renoir worked side by side painting the floating café. We carry on as far as Bougival to see where other Impressionists set up their easels and compare the view today with the one they painted. Some say Impressionism was born here. We then take the van to visit the Marmottan Museum where over 100 of Monet's paintings are housed. Here you will also see work by most of the other Impressionists like Renoir, Sisley and Caillebotte. There was great friendship amongst this school of artists and Monet worked alongside many of them during his lifetime. Lunch is at the bustling restaurant Chez Clement after which we cruise to Conflans Ste. Honorine at the confluence of the Seine and the Oise rivers. We moor a little outside the town at a peaceful country village where we can enjoy a barbecue on deck.

Saturday

Our cruising area today takes us further up the River Oise to Auvers-sur-Oise where Van Gogh lived and which he introduced to the world through his painting "L'Eglise d'Auvers", (Auvers' Church). We take lunch in the Auberge Ravoux where Van Goch spent his last days and visit the fascinating museum dedicated to him. A short walk or van ride takes us to the Chateau d'Auvers where we take a multi-media journey back in time into the Age of the Impressionists.

We then return to La Chouette and cruise down river to re-join the Seine at Conflans Ste.

Phone: 888.550.8580
Phone: 530.274.0764



Email: info@bargeconnection.com
Website: www.bargeconnection.com

T H E B A R G E C O N N E C T I O N

SAMPLE ITINERARY

La Chouette

NORMANDY
MAINLY MONET CRUISE

Honorine where we moor for the night. Supper on board.

Sunday

An early start this morning to visit the local barges street market and stroll along the quay to see the many barges moored here, up to seven abreast. Cruise to Limay then take the van through some stunning countryside to Le Moulin de Fourges for lunch. This afternoon we drive to Giverny to see Monet's home and garden and the American Museum of Art. Supper on board

Monday

Our first cruise stop today is Mantes-la-Jolie. Free time to take a short walking tour of the town and visit the 12th Century Collegiate Church "Notre Dame" which is one of the most beautiful examples of gothic architecture. We then cruise to Rolleboise where we have lunch on board. This afternoon's visit is to Chateau de la Roche Guyon, parts of which are hidden in the depths of the cliff face. All along here the caves, hollowed out by pre-historic man, are now used as barns and garages. We can also visit Vétheuil, another of Monet's homes. Dinner tonight is at the restaurant of the Chateau de la Corniche which, as its name suggests, is poised high above the Seine with a fantastic panoramic view.

Tuesday

This morning's cruise is to the beautiful town of Les Andelys nestling under the impressive ruins of Chateau Gaillard built by Richard the Lionheart. After lunch on board we take the van to visit the stunning village of Lyon La Fôret and Chateau Vascoeuil with its marvellous sculptures. Dinner at Le Mistral.

Wednesday

Depart after breakfast and on the way to Rouen rail station we make one last and lasting visit to Rouen Cathédrale. No "Monet Experience" would be complete without this. During 1892 and 1893 Monet painted many versions of this subject, always, more or less from the same angle, but under different light conditions which made the changing forms all the more striking.

PLEASE NOTE: On alternate weeks the cruise will be in the opposite direction.

Phone: 888.550.8580
Phone: 530.274.0764



Email: info@bargeconnection.com
Website: www.bargeconnection.com

THE BARGE CONNECTION

SAMPLE ITINERARY

La Chouette

SHORT CRUISE OPTIONS

The 'Waterways of Paris'

B&B Weekend in Paris 3 Nights

Day 1: Guests are collected from their Paris location - e.g. hotel, rail station, airport—and are transferred to La Chouette moored in central Paris. Guests are welcomed on board with a Champagne cocktail and introduced to the crew and to their accommodation.

Guests are free to visit places of interest in Paris with any help and suggestions we can give.

Day 2: Breakfast is served on board La Chouette at a time to suit our guests after which they are free to continue their Paris sightseeing.

Day 3: After breakfast on board, and at a time to suit, the guests are escorted to their Paris place of choice.

N.B.: On one of the days, to suit the party, La Chouette will cruise “Under the Bridges of Paris” to show the city in an unforgettable way. Cruise lasts approximately two hours.

The 'Waterways of Paris' Cruise

B&B 4 Nights in Paris

Day 1: Guests are collected from their Paris location—e.g. hotel, rail station, airport—and are transferred in our air-conditioned mini-bus to La Chouette moored in the countryside an hour's ride from Paris. Guests are welcomed on board with a Champagne cocktail and introduced to the crew and to their accommodation.

We cruise on the beautiful river Marne to the magnificent city of Meaux dominated by its impressive cathedral and famous for Brie de Meaux cheese.

After an aperitif on board guests are escorted to one of Meaux's top restaurants for dinner.

Day 2: We cruise into Paris stopping on the way to explore Lagny a riverside town with a twice-weekly market and where we have lunch on board. Our entry to Paris “Under the Bridges of Paris” will thrill all sitting out on our deck and has never failed to impress.

Dinner at the restaurant Altitude 95 part way up the Eiffel Tower with the sun setting over the city skyline.

Day 3: Our morning's cruise takes us deeper into the Town of Paris along the Canal St. Martin with its double locks and outstanding iron swing bridges. Passing through the Basin de la Villette we head for the giant lock which will take us onto the Canal St. Denis. Passing the

Phone: 888.550.8580
Phone: 530.274.0764



Email: info@bargeconnection.com
Website: www.bargeconnection.com

T H E B A R G E C O N N E C T I O N

SAMPLE ITINERARY

La Chouette

SHORT CRUISE OPTIONS

space age-like sports stadium, the Stade de France, we head down to rejoin the river Seine then head downstream for Chatou.

Chatou is where Monet and Renoir, among many other Impressionist painters, congregated and painted life on the river. We will dine tonight at the very restaurant they frequented, Maison Fournaise, and feel their very presence on the balcony where Renoir painted his famous “Le Déjeuner des Canotiers”, the luncheon party of the boatmen.

Day 4: Cruising further downstream on the Seine we reach Conflans Ste. Honorine where we find hundreds of barges moored up to seven deep. This is one of France’s barge capitals. This is also where we turn off the river Seine and onto the river Oise. This takes us to a charming little town called Auvers-sur-Oise where Van Gogh lived the last few weeks of his short life and where in that time he painted sixty pictures. We dine at the very inn where he lived and choose from a menu with many of the dishes of his time. There is an interesting exhibition at the inn as well as a comprehensive audio-visual exhibition on Impressionism at the nearby Chateau d’Auvers.

Day 5: After breakfast on board we will transfer guests to the Paris location of their choice.

These are just sample itineraries that can be offered. We would adjust to each groups interests to customize the cruise.

Phone: 888.550.8580
Phone: 530.274.0764



Email: info@bargeconnection.com
Website: www.bargeconnection.com

THE BARGE CONNECTION

2008 PRICES

La Chouette

6 Night Cruises:

Thursday Departures

Charter for 4 guests \$17,700

Charter for 6 guests \$21,000

Shorter Cruises Available upon requests

Guests enjoy one meal per day in specially selected restaurants
(included in the charter price).

Cruise Departures

May 15 & 22 / Belgium Cruise

May 29 to June 26 / France (Burgundy, Champagne or Normandy)

August 28 to September 25 / France (Burgundy, Champagne or Normandy)

Prices for the Waterways of Paris Short Cruises - Available Upon Request

Phone: 888.550.8580
Phone: 530.274.0764



Email: info@bargeconnection.com
Website: www.bargeconnection.com

THE BARGE CONNECTION

CRUISE OPTIONS

La Chouette

'Mainly Monet' highlights:

- Champagne cruise through Paris
- Visit to the Marmottan museum to see more than 100 Monet paintings
- Impressionist multimedia spectacular at Château d'Auvers sur Oise
- Monet's home and gardens at Giverny
- Richard the Lionheart's 12th Century fortress at Les Andelys
- Rouen Cathedral

'Champagne Experience' highlights:

- Champagne cruise through Paris
- Private tasting of the famous Brie de Meaux cheese with Givry red wine
- Hautvillers, home of Dom Perignon, fabled creator of champagne
- Visit to Moët & Chandon's sister champagne caves of Mercier, including tasting
- Traditional French dinner at the table of a private champagne house
- Reims Cathedral

'A Taste of burgundy' highlights:

- Champagne Cruise through Paris.
- Barbizon, famed village of the Pre-Impressionist in the Fontainebleau Forest.
- Medieval town of Moret-sur-Loing.
- Private wine tasting at Cote St Jacques and visit to 12th century wine press.
- Magnificent spired city of Auxerre.
- Irancy, a picturesque village which produces superb red wine.
- More wine tasting. This time the world renowned dry white Chablis.

Phone: 888.550.8580
Phone: 530.274.0764



Email: info@bargeconnection.com
Website: www.bargeconnection.com

THE BARGE

CONNECTION

MENU TYPES

La Chouette

Roasted Red Peppers with Olive Tapenade and Tomato

Leg of Lamb with a red Wine Sauce Minted New Potatoes Seasonal Vegetables

Selection of French Cheeses

Baked Peaches with Vanilla Ice Cream

Coffee and Chocolates

Phone: 888.550.8580
Phone: 530.274.0764



Email: info@bargeconnection.com
Website: www.bargeconnection.com

THE BARGE CONNECTION

TERMS & CONDITIONS

La Chouette

INDIVIDUAL & CHARTER BOOKINGS:

- 30% deposit due upon booking to confirm booking
- Balance due 90 days prior to departure

CANCELLATIONS:

- Both deposits and final payments are non-refundable, unless space is resold
- In that case, 90% of the monies deposited would be refunded

La Chouette reserves the right to cancel any cruise prior to or during the cruise if in their reasonable opinion they consider the cruise may constitute a danger due to unforeseen events such as flooding, drought, riots, war and the like or events which make it impracticable or impossible to continue the cruise, including but not limited to any illness, health or personal matters. In such cases any sums received from the client will be refunded based on the cost of the unfinished portion of the cruise and the guests will forfeit any further claim on La Chouette cruises for any reason whatsoever.

All cancellations must be made in writing and sent to the Barge Connection
Cancellation Insurance is highly recommended

Phone: 888.550.8580
Phone: 530.274.0764



Email: info@bargeconnection.com
Website: www.bargeconnection.com

THE BARGE CONNECTION