

Bon Vivant

CRUISING THE UPPER LOIRE REGION OF FRANCE

The Barge Connection
12036 Nevada City Highway #311
Grass Valley, CA 95945
Phone 888.550.8580
Phone 530.274.0764
Fax 530.274.0825
www.bargeconnection.com
Email info@bargeconnection.com

Version 1
1.1.02



THE BARGE

CONNECTION

TECHNICAL SPECIFICATIONS

Bon Vivant

SPECIFICATIONS

Size:	128"X16'6"
Capacity:	8
Crew:	4
Cabins:	4
Accommodations:	4 Double-Twin Staterooms
Heat & Air:	Central Heating & Air Conditioning
Cruising Region:	Upper Loire
Length of Cruise:	6 Nights
Departure Day:	Sunday
Meals:	All Included
Beverages:	All Included
Entrance Fees:	All Included
Laundry Facilities:	Not available
Hairdryers:	Included
Transportation:	Transfers to and from Paris & Private Motorcoas for excursions
Pick-Up Location:	Rail Station or Hotel in Paris
Pick-Up Time:	To Be Advised
Recreational Items:	Soundsystem with CD, 8 Bikes, Fully Stocked Bar, Library of books & Jacuzzi (shaped like a wine barrel)
Cruising Season:	April until November

BOAT DIAGRAM

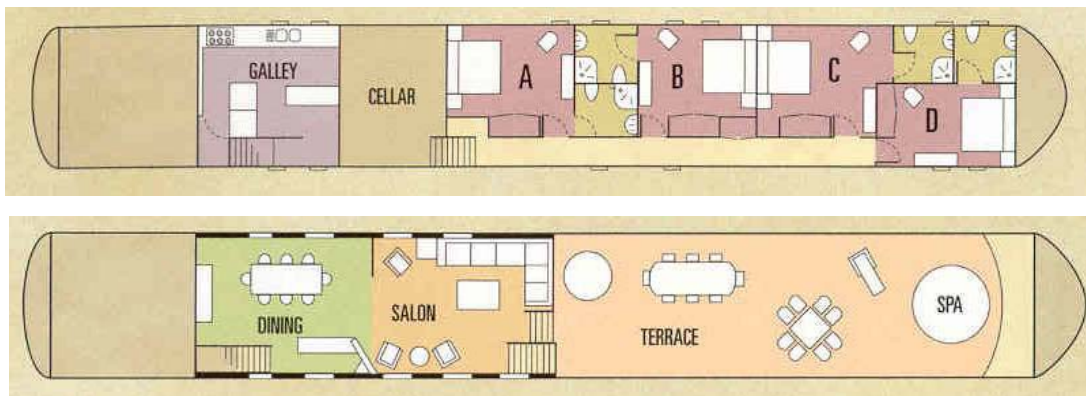

Version 1
1.1.02

Phone: 888.550.8580
Phone: 530.274.0764



Email: info@bargeconnection.com
Website: www.bargeconnection.com

T H E B A R G E

C O N N E C T I O N

SAMPLE ITINERARY

Bon Vivant

NEVERS TO BRIARE

Sunday

An escort will transfer you from Paris; transfer to the boat for reception, short cruise and dinner on board.

Monday

Cruise from Nevers to Cours Les Barres, passing the Canal Bridge at "Le Guetin" over the Allier River. Visit Apremont sur Alier with its magnificent Chateau and floral park set in a beautiful, perfectly restored medieval village. Visit Nevers and the Frederic Blandin Ceramic Museum; walk through the old streets offering many shopping opportunities.

Tuesday

Cruise from Cours Les Barres to La Chapelle Molinard. Visit La Charite Sur Loire, an important site for Burgundian Romanesque art and a renowned stopping place on the ancient pilgrimage route to Santiago de Compostella; visit the Cellier du Gout Center. Have a wine tasting at Pouilly Sur Loire overlooking a beautiful Chateau.

Wednesday

Cruise from La Chapelle Molinard to St. Satur at the foot of Sancerre. Visit Sancerre and admire the magnificent panoramic view over the Loire Valley; have a wine tasting at Chavignot, visit a goat cheese farm where world famous cheese is produced.

Thursday

Cruise from St. Satur to Belleville Sur Loire. Visit Cosne Sur Loire and its Museum of the Loire. Tour Chateau de Biancafort and Chateau de St. Fargeau and the pottery art at St. Armand en Puisaye.

Friday

Cruise from Belleville to Briare passing the world famous aqueduct built by Eiffel, designer of the Eiffel Tower in Paris. Shop at Gien for faience before visting Chateau de Gien known for its hunting trophies and art illustrating all aspects of hunting. Visit Chateau de la Bussiere, a private chateau with a splendid vegetable garden and its private collection dedicated to fishermen.

Version 1
1.1.02

Phone: 888.550.8580
Phone: 530.274.0764



Email: info@bargeconnection.com
Website: www.bargeconnection.com

T H E B A R G E

C O N N E C T I O N

SAMPLE ITINERARY

Bon Vivant

NEVERS TO BRIARE

Saturday

Breakfast on board. Morning return to Paris.



Version 1
1.1.02

Phone: 888.550.8580
Phone: 530.274.0764



Email: info@bargeconnection.com
Website: www.bargeconnection.com

THE BARGE

CONNECTION

MENU TYPES

Bon Vivant

Begin your day

whenever it suits you - with fresh croissants and rolls fresh from a nearby bakery, local butter and jam; fresh coffee, tea, juice, yogurt, fresh fruit and cereal. Comfort food. Eden revisited.

Lunch

might be quiche, or an interesting tart, a savory soup for a cold day, the freshest of salads and a selection of cheeses (the kind made locally and unavailable anywhere else at any cost). Depending on the day, or your whim, take lunch inside - or out on the deck where you can watch life pass you by in all its natural glory.

Dinner

is a celebration - after all, it's the end of the day and the beginning of the evening! Perhaps it will be a succulent roast duck, or mouth-watering local fish, or how about something exotic like wild boar, each accompanied by the freshest vegetable dishes. Course follows course, wines abound. After all this, dessert can still leave you starry-eyed: *tarte tatin*, *creme brulee*, *chocolate delicie* - any fancy name will suffice, the word resistance is not in your vocabulary.

Version 1
1.1.02

Phone: 888.550.8580
Phone: 530.274.0764



Email: info@bargeconnection.com
Website: www.bargeconnection.com

T H E B A R G E

C O N N E C T I O N