

Actief

CRUISING THE UPPER THAMES IN ENGLAND

The Barge Connection
2036 Nevada City Highway #311
Grass Valley, CA 95945
Phone 888.550.8580
Phone 530.274.0764
Fax 530.748.0101
www.bargeconnection.com
Email info@bargeconnection.com

06/30/08



THE BARGE CONNECTION

TECHNICAL SPECIFICATIONS

Actief

SPECIFICATIONS

Size:	100'X16'6"
Capacity:	11
Crew:	4
Cabins:	6 (all with private bath)
Accommodations:	3 Suites, 2 Twins & 1 Single
Heat & Air:	Central Heat
Cruising Region:	Upper Thames
Length of Cruise:	6 Nights
Departure Day:	Sunday
Electricity:	220 volt generator
Engine:	120 DAF, maximum speed 8 knots
Water:	6 tons of water and 3 tons of fuel
Meals:	All Included
Beverages:	All Included
Entrance Fees:	All Included
Hairdryers:	Supplied
Laundry Facilities:	Not available
Transportation:	Transfers to and from London & Private Motorcoach for excursions
Pick-Up Location:	Goring Hotel, Beeston Place, Grosvenor Gardens, London SW1
Pick-Up Time:	2:00 PM
Recreational Items:	Stocked bar built from oak, Library, Stereo Soundsystem with CD
Theme Cruises:	Golf, Antique, Garden, Family Regatta & Walking
Cruising Season:	April until November

BOAT DIAGRAM

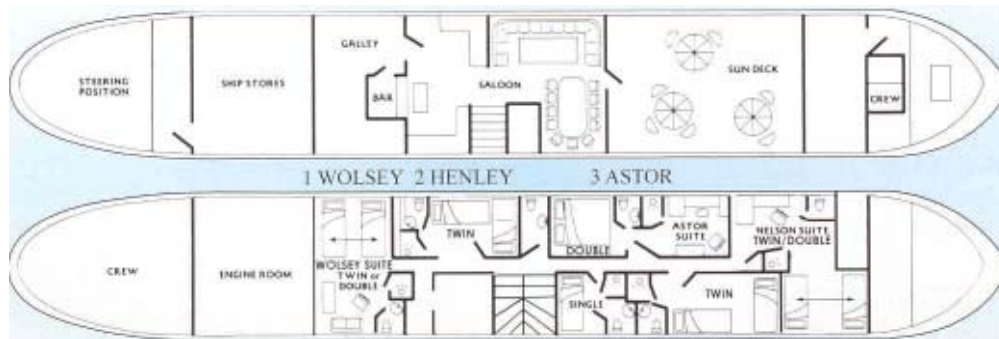

06/30/08

Phone: 888.550.8580
Phone: 530.274.0764



Email: info@bargeconnection.com
Website: www.bargeconnection.com

THE BARGE

CONNECTION

SAMPLE ITINERARY

Actief

SHILLINGFORD TO WINDSOR

Sunday

Private transfer from the Goring Hotel in London to our mooring at Shillingford Bridge. After a traditional English cream tea on arrival there is a late afternoon cruise and a chance to settle in to your comfortable and attractive cabins. The evening commences with a festive champagne reception followed by dinner and your first night aboard.

Monday

This morning's cruise is through glacier formed hills to our mooring alongside the 17th century Swann Inn at Pangbourne. After lunch we visit Oxford - 'City of Dreaming Spires'. View the grandest of all Oxford's Colleges, Christchurch, founded by Henry VIII in 1525 and the setting for the tale of Alice in Wonderland. This is followed by time for shopping and afternoon tea before returning to Actief

Tuesday

This morning our cruise continues through sylvan countryside (setting for Kenneth Grahame's 'Wind In The Willows') to the picturesque Mapledurham Estate. Here we privately visit Elizabethan Mapledurham House, home to descendants of the same family since 1490, and Mapledurham Mill, a 500 year old still working water mill (famously used during the filming of 'The Eagle Has Landed'). Afterwards our cruise continues until reaching our overnight stop at Henley-On-Thames.

Wednesday

A picturesque early morning cruise brings us to elegant Henley-On-Thames. This morning we visit the spectacular new and interactive River and Rowing Museum. No ordinary museum, this is a wonderful chance to learn something of the secrets, mythology, history and traditions of the River Thames. After lunch there is time to catch up on some shopping in this fashionable town, home to the world famous annual Henley Royal Regatta. A late afternoon cruise takes us to the picturesque medieval village of Hurley

Thursday

A gentle walking tour around Hurley, home of Ye Olde Bell, reputedly England's oldest Inn founded for visiting monks in 1135, is followed by a visit to Peter Freebody's traditional boatyard. Peter's family has been involved in the river for 800 years! We then cruise to one of the most stunning reaches on the river at Cliveden and our private mooring at this magnificent estate, former home of the Astors. Our tour of the fabulous gardens with breathtaking

06/30/08

Phone: 888.550.8580
Phone: 530.274.0764



Email: info@bargeconnection.com
Website: www.bargeconnection.com

T H E B A R G E

C O N N E C T I O N

SAMPLE ITINERARY

Actief

SHILLINGFORD TO WINDSOR

views is most memorable

Friday

A delightful morning cruise takes us to our final mooring below magnificent Windsor Castle. After lunch we visit Eton College, founded in 1440 and current school to Prince Harry. The museum of Eton Life gives a fascinating insight into the education of Britain's premier scions over the centuries. Following this there is time for you to browse the many shops in Eton and Windsor. Tonight the Captain hosts his farewell dinner, based on a period banquet

Saturday

After breakfast we return to London.

NOTE: On alternate weeks, cruise will be in reverse direction. This is a sample itinerary and is subject to change.

06/30/08

Phone: 888.550.8580
Phone: 530.274.0764



Email: info@bargeconnection.com
Website: www.bargeconnection.com

T H E B A R G E

C O N N E C T I O N

SAMPLE ITINERARY

Actief

GOLF CRUISE

Sunday

Private transfer from the Goring Hotel in London to our mooring at Shillingford Bridge. Traditional English cream tea on arrival is followed by a delightful afternoon cruise through beautiful water meadows. This is followed by a festive champagne reception, dinner and your first night on board Actief.

Monday

This morning you depart for your first round of golf at Huntercombe Golf Club, founded in 1901 by renowned Scottish professional Willie Park Jr. and much praised by Walter Travis, the first great American amateur. With a fascinating history Huntercombe is much loved and remains a fine and beautiful course in a glorious part of the countryside. Following lunch you take a leisurely afternoon cruise through the ancient town of Wallingford and between steep glacier formed hills to your next mooring alongside the 17th century Swann Inn at Pangbourne. After lunch you depart for a round at Huntercombe Golf Club, founded in 1901 by renowned Scottish professional Willie Park Jr. and much praised by Walter Travis, the first great American amateur. With a fascinating history Huntercombe is much loved and remains a fine and beautiful course in a glorious part of the countryside.

Tuesday

This morning you leave for a round at Sunningdale Golf Club. Sunningdale was established in 1901 and is ranked as one of the top 20 courses in the world... It is a 6187m, par 70 heathland course. Lunch is followed by today's cruise is through true 'Wind In The Willows' country where author Kenneth Grahame penned his immortal tales of Toad, Ratty and Mole and on through the villages of Sonning, Wargrave and Shiplake, until reaching your overnight mooring at Henley-On-Thames.

Wednesday

This morning you leave Henley for a round at Denham Golf Club, a prestigious private members club founded in 1911 and designed by renowned golf architect Harry Shapland Colt (in 1913 he was involved for a brief but critical period in the lengthy construction of Pine Valley in America). After returning to Actief for lunch the day ends with a cruise along the famous 'Regatta Mile' to our overnight mooring at Hurley.

06/30/08

Phone: 888.550.8580
Phone: 530.274.0764



Email: info@bargeconnection.com
Website: www.bargeconnection.com

T H E B A R G E

C O N N E C T I O N

SAMPLE ITINERARY

Actief

GOLF CRUISE

Thursday

Hurley is a wonderful old village and a gentle walking tour allows a glimpse of medieval life before you continue your cruise. The next stop is at our private mooring at the picturesque boathouse of Cliveden. From here you depart for a round at Stoke Poges Golf Club, recently voted 'Golf Club of the Year' out of 2,200 clubs. The unique 18th century clubhouse was built for John Penn, grandson of the Honourable William Penn, founder of Pennsylvania.

Friday

This morning your final cruise through gentle countryside takes you to our mooring at Windsor, below a magnificent view of the castle. After lunch you leave for Wentworth Golf Club. Almost needing no introduction, Wentworth is considered one of Europe's finest clubs and famous for the PGA and World Match Play tournaments as well as many other events.

Saturday

9.30am: Disembark and private transfer to London Heathrow Airport or the Goring Hotel.

IMPORTANT - Golf course requirements:

Sunningdale: Handicap certificates required - 18 or under for gentlemen and 20 or under for ladies. Letters of introduction from players' own club required.

Stoke Poges: Handicap certificates required - 24 or under for gentlemen and 34 or under for ladies

Denham: Handicap certificates required - 24 or under for gentleman and 36 or under for ladies

Wentworth: Handicap certificates required - 24 or under for gentlemen and 32 or under for ladies

NB because these courses are very much in demand we cannot guarantee availability. In the event that a course is unavailable we reserve the right to provide an alternative course.

06/30/08

Phone: 888.550.8580
Phone: 530.274.0764



Email: info@bargeconnection.com
Website: www.bargeconnection.com

T H E B A R G E

C O N N E C T I O N

SAMPLE ITINERARY

Actief

ANTIQUE CRUISE

Sunday

Private transfer from the Goring Hotel in London to your mooring at Windsor where cream tea on arrival is followed by a visit to Windsor Castle for a tour of the State Apartments. This evening there is a champagne welcome, followed by dinner and your first night aboard.

Monday

After breakfast there is time to visit the interesting, renowned antique shops of beautiful Eton before today's river journey. Your cruise takes you to the stunning Cliveden Reach and our private mooring at the picturesque boathouse of Cliveden. The tour of this magnificent estate, former home of the Astors, concentrates on the gardens with their especially stunning views. There is plenty to amuse the antiques aficionado including 18th century Venetian statues and the restored Pagoda made for the Paris Exhibition of 1867.

Tuesday

Enjoy a relaxing cruise through unspoilt countryside to the beautiful medieval village of Hurley. A gentle walking tour of this ancient village allows you to glimpse many reminders of long-ago life, including 'Ye Olde Bell'. This is reputedly England's oldest inn, founded in 135AD. There is also a visit to Peter Freebody's boatyard - Peter's family has been involved with the river for 800 years! Continuing this tradition he and his team of skilled craftsmen build and restore antique steam launches. The day ends with a cruise along the world famous Royal Regatta mile into Henley-on-Thames.

Wednesday

This morning you visit Woodward & Willow, who have an eye for the unusual. This is followed by visit to The 'Country Seat' (housed in an historic Tithe Bar, built. Specifically for holding 'tithes' or the tenth part of agricultural produce everyone paid to the church in medieval times) and Holidays, two internationally renowned antiques venues. Whilst very different in style they both specialize in 17th, 18th, 19th century furniture and artifacts. Following lunch your afternoon cruise takes you to the ancient village of Sonning, founded as an abbey settlement in 909AD.

Thursday

The day commences with an early morning stroll around Sonning and then your cruise takes you thru' sylan countryside to the picturesque Mapledurham Estate. Here you privately visit Elizabethan Mapledurham House, home to descendants of the same family since 1490, and

06/30/08

Phone: 888.550.8580
Phone: 530.274.0764



Email: info@bargeconnection.com
Website: www.bargeconnection.com

T H E B A R G E

C O N N E C T I O N

SAMPLE ITINERARY

Actief

ANTIQUÉ CRUISE

where you can enjoy many family heirlooms on their original setting. You will also have the chance to look at the Mapledurham Mill, a 500 year old still working water mill (famously used during the filming of "The Eagle has landed")

Friday

Friday morning is spent cruising through the steep hills of the Goring Gap formed during the ice age, and on to your final mooring at Shillingford Bridge. Following lunch you visit the annual Oxford Antiques Fair where an Aladdin's cave of treasures awaits your inspection. Finally, before returning to Actief, you visit Ewelme, a beautiful village forever associated with the name of Chaucer. The great poet's son, daughter-in-law and grand-daughter lie buried in impressive tombs in the little altered 15th century church.

Tonight the Captain hosts his farewell dinner, based on a period banquet.

Saturday

9.30am: Disembark and private transfer to London Heathrow Airport or the Goring Hotel.

On two separate evenings during your cruise, witty and knowledgeable antiques experts from the Thames Valley Antique Dealers Association will give an enjoyable and informative pre-dinner talk. They will then join you for dinner.

06/30/08

Phone: 888.550.8580
Phone: 530.274.0764



Email: info@bargeconnection.com
Website: www.bargeconnection.com

T H E B A R G E

C O N N E C T I O N

2008 PRICES

Actief

	VALUE SEASON	REGULAR SEASON
Suite per guest	\$3,450	\$3,770
Twin Cabin per guest	\$2,930	\$3,250
Single Cabin	\$3,140	\$3,450
Single Guest in a Dbl Suite	\$5,180	\$5,650
Single Guest in a Twin Cabin	\$4,390	\$4,860
Charter for 6 guests	\$24,100	\$25,150
Charter for 7 guests	\$25,570	27,250
Charter for 8 guests	\$27,040	\$29,350
Charter for 9 guests	\$28,510	\$31,450
Charter for 10 guests	\$29,980	\$33,550
Charter for 11 guests	\$31,450	\$35,650

VALUE SEASON: April 6, 13, 20, 27; July 27; August 3, 10, 17, 24; October 5, 12, 19

REGULAR SEASON: May 4, 11, 18, 25; June 1, 8, 15, 22, 29; July 6, 13, 20; August 31; September 7, 14, 21, 28; October 26

Children under 14 are welcome only on board as part of a charter group or on the dedicated family week. Children of 17 or under receive a \$350 discount on charter bookings and 'Family Cruises', and a discount of US\$350 for 14-17 yr olds in cabin bookings. No charge for children 2 or under, sharing a cabin with an adult. Please note April cruises require a minimum of 4 guests, all others require a minimum of 2 guests.

Special Departures in 2008

May 18, 2008 - Chelsea Flower Show

June 29, 2008 - Henley Royal Regatta

July 6, 2008 - Hampton Court Palace Flower Show

July 20, 2008 - Family Week

October 26, 2008 - Antiques Week

06/30/08

Phone: 888.550.8580
Phone: 530.274.0764



Email: info@bargeconnection.com
Website: www.bargeconnection.com

T H E B A R G E

C O N N E C T I O N

2009 PRICES

Actief

	VALUE SEASON	REGULAR SEASON
Suite per guest	\$3,450	\$3,770
Twin Cabin per guest	\$2,930	\$3,250
Single Cabin	\$3,140	\$3,450
Single Guest in a Dbl Suite	\$5,180	\$5,650
Single Guest in a Twin Cabin	\$4,390	\$4,860
Charter for 6 guests	\$24,100	\$25,150
Charter for 7 guests	\$25,570	27,250
Charter for 8 guests	\$27,040	\$29,350
Charter for 9 guests	\$28,510	\$31,450
Charter for 10 guests	\$29,980	\$33,550
Charter for 11 guests	\$31,450	\$35,650

VALUE SEASON: April 5, 12, 19, 26; October 4, 11, 18 & 25

REGULAR SEASON: May 3, 10, 17, 24, 31; June 7, 14, 21, 28; July 5, 12, 19, 26; August 2, 9, 16, 23, 30; September 6, 13, 20 & 27

Golf \$1500 per person - Charter only minimum of 6 required

Walking Cruise: \$2000 - Charter only

All April Cruises require four passengers booked to guarantee the cruise. All other departures only require two passengers booked.

Children under 14 are welcome only on board as part of a charter group or on the dedicated family week. Children of 17 or under receive a \$350 discount on charter bookings and 'Family Cruises', and a discount of US\$350 for 14-17 yr olds in cabin bookings. No charge for children 2 or under, sharing a cabin with an adult. Please note

April cruises require a minimum of 4 guests, all others require a minimum of 2 guests.

06/30/08

Phone: 888.550.8580
Phone: 530.274.0764

Email: info@bargeconnection.com
Website: www.bargeconnection.com

T H E B A R G E

C O N N E C T I O N

MENU TYPES

Actief

Roasted Tomato Soup with Puree of Basil & Croutons

Elderflower Sorbet

Butterfly Leg of Lamb with
Rosemary & Garlic, Dauphinois Potato Cakes,
Savoy parcels and Baked Carrots with Cumin

Hazelnut & Raspberry Vacherins with Raspberry Coulis

Regional Cheeseboard

Coffee and Liqueurs

06/30/08

Phone: 888.550.8580
Phone: 530.274.0764



Email: info@bargeconnection.com
Website: www.bargeconnection.com

T H E B A R G E

C O N N E C T I O N