

Absoluut 2

CRUISING HOLLAND

The Barge Connection
2036 Nevada City Highway #311
Grass Valley, CA 95945
Phone 888.550.8580
Phone 530.274.0764
Fax 530.274.0825
www.bargeconnection.com
Email info@bargeconnection.com



T H E B A R G E

C O N N E C T I O N

TECHNICAL SPECIFICATIONS

Absoluut 2

SPECIFICATIONS

| | |
|---------------------|--|
| Size: | 128"X16'5" |
| Capacity: | 8 |
| Crew: | 5 |
| Cabins: | 4 cabins with private bath |
| Cabin Dimensions: | Suite 1 / 167 sq feet, Suite 4 / 137 sq feet, cabins 2 & 3 / 111 sq feet |
| Accommodations: | 4 Queens/Twins |
| Suite: | Captain's Suite Available for Charters \$250 Supplement |
| Heat & Air: | Central Heating & Air Conditioning |
| Cruising Region: | Holland |
| Length of Cruise: | 6 Nights |
| Departure Day: | Sunday |
| Meals: | All Included |
| Beverages: | All Included (open bar) |
| Entrance Fees: | All Included |
| Laundry Facilities: | Not available |
| Transportation: | Transfers to and from Amsterdam & Private Motorcoach for excursions |
| Pick-Up Location: | L'Europe Amsterdam, Nieuwe Doelenstraat 2-8, 1012 CP Amsterdam |
| Pick-Up Time: | 2:00 PM |
| Recreational Items: | Separate sundeck with exercise bike and four person Jacuzzi, satellite TV in each cabin, email access, soundsystem with CD, internet outlet in each cabin, 18 speed 8 bicycles, Library of books & games |
| Salon/Sitting Area: | with new leather sofas and nice dining area for eight with picture windows |
| Vehicle Used: | 8-seater, air-conditioned Mercedes Benz minibus |
| Cruising Season: | Holland in Spring only for 2009 |

BOAT DIAGRAM

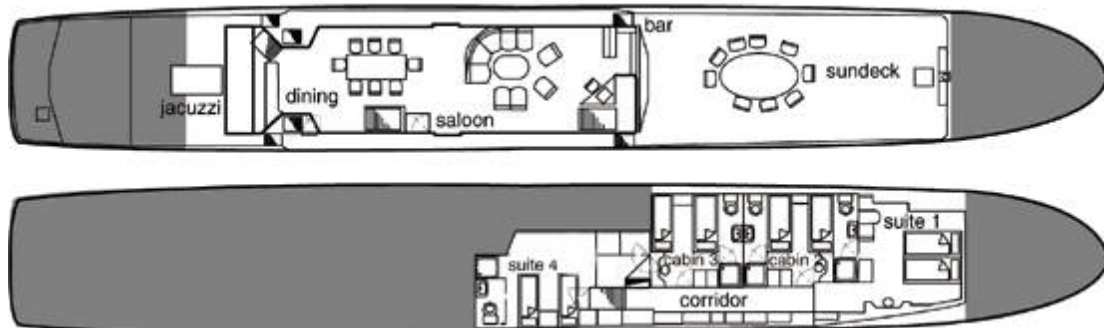

06/30/08

Phone: 888.550.8580
Phone: 530.274.0764



Email: info@bargeconnection.com
Website: www.bargeconnection.com

T H E B A R G E

C O N N E C T I O N

SAMPLE ITINERARY

Absoluut 2

HOLLAND TULIP CRUISE

Sunday

You are met at your hotel in Amsterdam at 2.00 pm and driven through the scenic heart of Holland to Absoluut2 for a champagne welcome onboard. We begin our cruise with a trip through Rotterdam harbour, the second largest in the world, past an amazing display of Dutch architecture both modern and ancient. From there we head north up the river IJssel to our first mooring and your first gourmet meal onboard in the quaint town of Gouda.

Monday

After breakfast there is time to explore the historic riches of Gouda including the fascinating St John church, dating back to 1280 with it's colourful stained glass windows, the picture-perfect town hall and square plus the Waag where the famous Gouda cheese has been weighed since 1668. Then back to Absoluut2 for a lunch cruise through some of Holland's most beautiful countryside to our next overnight stop in Haarlem.

Tuesday

Spend the morning shopping in the cosmopolitan town of Haarlem followed by a visit to the Great church of St. Bavo's. This gothic masterpiece houses the Christian Muller organ, which was graced by the likes of Handel and the very young Mozart. Our afternoon is taken up viewing the fields of tulips drifting by as we head north up the Spaarne to the region of Zaandam with its traditional Dutch green 'dollhouse' architecture.

Wednesday

This morning, we visit the historic village of Zaan Schaans with its working windmills, clog makers, cheese farm and mustard mill. Everything that the Dutch are famous for can be found here in this tiny village. A real treat and an 'absoluut' must for anyone travelling to Holland. We meet up with Absoluut2 for an afternoon cruise through the centre of Amsterdam. Past the lifting bridges and canal houseboats to our mooring for the night in the peaceful countryside of the Amstel River.

Thursday

If flowers are your passion then one of the highlights of the voyage will definitely be the visit to Keukenhof gardens. Stroll through 32 hectares of glorious color and scent as you are immersed in a sea of flowers in this unique park. Absoluut-ly breathtaking. After lunch we cruise to Delft to spend the afternoon wandering through this fascinating city and see first-hand the artisans that make of the Royal Delftware porcelain.

06/30/08

Phone: 888.550.8580
Phone: 530.274.0764



Email: info@bargeconnection.com
Website: www.bargeconnection.com

T H E B A R G E

C O N N E C T I O N

SAMPLE ITINERARY

Absoluut 2

HOLLAND TULIP CRUISE

Friday

After breakfast and a short morning cruise we find ourselves in fascinating town of Schiedam. This little town has some amazing sights including six of the world's largest working traditional windmills, a glass museum, a chocolate art factory, historic boat harbour plus it is also famous for it's Jenever (Dutch gin) distilleries. So a visit to the gin museum and tasting room is a must.

Saturday.

Enjoy a leisurely breakfast before we return you to the airport or your hotel

06/30/08

Phone: 888.550.8580
Phone: 530.274.0764

Email: info@bargeconnection.com
Website: www.bargeconnection.com

T H E B A R G E

C O N N E C T I O N

MENU TYPES

Absoluut 2

Continental breakfast

Champagne or Juice

*A selection of freshly baked pastries and breads,
with various butters & preserves*

Cereals, fruit & yogurt

Coffee or tea selection

Lunch

When dining aboard Absoluut2 lunch will be served on deck buffet style, or inside in the dining room depending on your preference

A selection of salads: warm chevre with rocket, salad pomme de terre, salad caprese Quiche Lorraine with warm mediterranean char-grilled vegetables

Charcuterie Platters of quality cold meats and local specialities Traditional French fine herb omelet

Pan-fried foie gras with a prune and eau de vie jus A selection of local cheese

Dessert of the day

Coffee or Tea

Dinner

Entrée (starter)

Salad nicoise - Green bean and potato salad with tuna and anchovies

Gnocchi verts - Handmade potato & Basel pasta with a tomato & herb sauce

Champignon farcee- Stuffed mushrooms Saumon gravadlux mesclun- Salmon carpaccio on a bed of mixed salad leaves

Main Course (entrée)

Fillet de boeuf au poivre - The finest French Charolais beefsteak with a merlot and mushroom jus

Noix de St Jacques avec epinard - Sea scallops served on a bed of spinach

Lotte menieure au citron vert- Grilled Monk fish in butter and lime sauce

All dishes served with vegetables fresh from the market daily.

Cheese Board Each night a selection of French cheeses

With a description of the cheese & the region,

Accompanied by specially selected wines.

Desserts

A selection of traditional, all time favorites.

Chocolate mousse

06/30/08

Phone: 888.550.8580
Phone: 530.274.0764



Email: info@bargeconnection.com
Website: www.bargeconnection.com

T H E B A R G E

C O N N E C T I O N

CRUISE SCHEDULE & PRICES

Absoluut 2

2009

| | | |
|-----------|----------------|-----|
| March-29 | Holland Cruise | Low |
| Apr-05 | Holland Cruise | Low |
| Apr-12 | Holland Cruise | Reg |
| Apr-19 | Holland Cruise | Reg |
| Apr-26 19 | Holland Cruise | Reg |
| May-03 20 | Holland Cruise | Reg |
| May-10 21 | Holland Cruise | Reg |
| May-17 22 | Holland cruise | Reg |
| May-24 23 | Holland cruise | Low |
| May-31 24 | Holland cruise | Low |

Reg Season

| | |
|-------------------------------|----------------|
| 8 Pass Charter | \$39,500 |
| 6 or less Charter | \$37,200 |
| Per Person (double occupancy) | \$5,325 * p.p. |

Low Season

| | |
|-------------------------------|----------------|
| 8 Pass Charter | \$37,250 |
| 6 or less Charter | \$33,500 |
| Per Person (double occupancy) | \$5,050 * p.p. |

*Additional Supplement of \$250 for Captain's suite.
Single Supplement \$2,250

2008 Season Booked

2009 Season Holland During Spring Only

06/30/08

Phone: 888.550.8580
Phone: 530.274.0764



Email: info@bargeconnection.com
Website: www.bargeconnection.com

T H E B A R G E

C O N N E C T I O N

TERMS & CONDITIONS

Absoluut 2

2009

We welcome children of all ages on Charter bookings and children over 16 on bookings made by the Cabin. Departures are guaranteed with a minimum of 4 passengers. In the event we have less than four passengers we reserve the right to cancel the cruise.

All bookings will be secured upon receipt of a 25% deposit.

The balance of the payment must be received at least 90 days prior to departure.

Cancellation policy

More than 90 days prior to departure, all deposits (25%) will be non-refundable.

90 days or less prior to departure, the entire cost is non-fundable

Trip cancellation insurance is strongly recommended.

YOUR TOUR PRICE INCLUDES:

All accommodation whilst on-board

All meals and beverages, including unlimited wine with meals from our selection, bar drinks and liqueurs from our bar, all normal hot and cold drinks.

Sightseeing trips as determined by the daily schedule including applicable entrance fees.

Use of bicycles.

Transfers between absoluut2 and Hotel Europe in Amsterdam or Sofitel Le Parc in Paris depending on the cruise route or hotel of your choice in Amsterdam or Paris for charter bookings depending on the cruise route.

The tour price includes all planning, handling and operational charges and is quoted at the rate of exchange and tariff effective on signature date. In the event of a material increase (10%) in foreign currency or in tariff rates, prices may be subject to revision.

NOT INCLUDED IN THE TOUR PRICE:

Air travel and taxes, laundry, personal insurance, excess baggage fees, communication charges, cost of obtaining passport, all items of a personal nature.

Optional Extras:

We are able to arrange special excursions and trips by arrangement such as Hot-air ballooning and golfing.

Gratuities: It is customary to show your appreciation to your crew (normally 5-10%).

06/30/08

Phone: 888.550.8580
Phone: 530.274.0764



Email: info@bargeconnection.com
Website: www.bargeconnection.com

T H E B A R G E

C O N N E C T I O N