

Absoloot 2

CRUISING THE BURGUNDY & CHAMPAGNE REGIONS OF FRANCE

The Barge Connection
2036 Nevada City Highway #311
Grass Valley, CA 95945
Phone 888.550.8580
Phone 530.274.0764
Fax 530.274.0825
www.bargeconnection.com
Email info@bargeconnection.com



T H E B A R G E C O N N E C T I O N

TECHNICAL SPECIFICATIONS

Absoluut 2

SPECIFICATIONS

Size:	128"X16'5"
Capacity:	8
Crew:	5
Cabins:	4
Accommodations:	4 Queens/Twins
Captain's Suite:	Available for Charters \$250 Supplement
Heat & Air:	Central Heating & Air Conditioning
Cruising Region:	Ile de France, Burgundy & Champagne
Length of Cruise:	6 Nights
Departure Day:	Sunday
Meals:	All Included
Beverages:	All Included
Entrance Fees:	All Included
Laundry Facilities:	Not available
Transportation:	Transfers to and from Paris & Private Motorcoach for excursions
Pick-Up Location:	Hotel le Colbert - 7, Rue de l'hôtel Colbert, 75005 Paris <i>When chartering you can be transferred from a hotel of your choice in Paris</i>
Pick-Up Time:	2:00 PM
Recreational Items:	TV, Wi-Fi, email access, sound system with CD, 8 bicycles, Library of books & games
Cruising Season:	France / June to November Holland / March to May

BOAT DIAGRAM

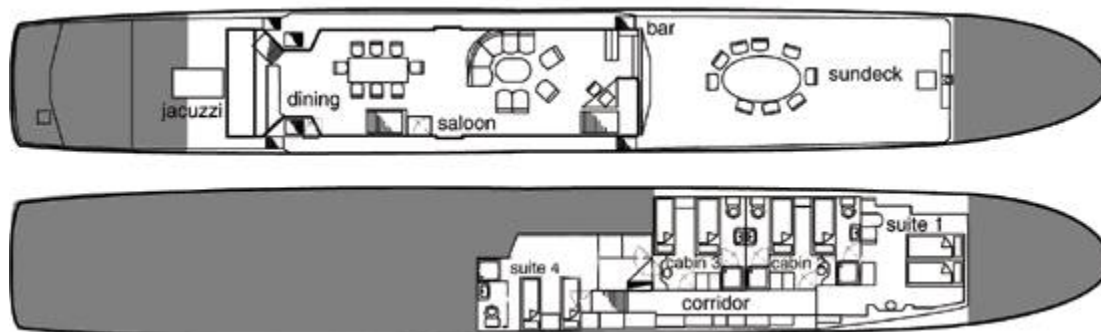

01/01/08

Phone: 888.550.8580
Phone: 530.274.0764



Email: nfo@bargeconnection.com
Website: www.bargeconnection.com

T H E B A R G E

C O N N E C T I O N

SAMPLE ITINERARY

Absoloot 2

PARIS TO AUXERRE

2008

Sunday

You will be met at your hotel at 2.00pm and chauffeured to Absoloot2 moored in Paris for a champagne welcome. Once you're settled in you'll spend the afternoon marveling at the sights of Paris from the deck as we cruise past Notre Dame cathedral, the Louvre museum, the Statue of Liberty and the Eiffel Tower. We will moor that night just out of town, in the quiet, where you will enjoy your first gourmet dinner on board.

Monday

After breakfast there is an excursion to a Baroque style chateau—the Vaux-le-Vicomte. After lunch on to the charming 12th Century medieval village of Moret, where the Impressionists Monet, Renoir and Sisley sought inspiration.

Tuesday

This morning we visit the gardens and stables of Fontainebleau. Then cruise on the upper part of the Seine to Montereau, where the River Yonne meets us.

Wednesday

A pleasant morning cruise along the beautiful River Yonne to the lovely little town of Sens. The afternoon's excursion to one of the largest and finest gothic cathedrals in Europe, St-Etienne will leave you in awe; it is a magnificent building that took over 300 years to construct. There is plenty of time to shop, visit the museum or stroll around the town.

Thursday

Winding up the River we arrive at the riverside town of Joigny, with its houses of sculpted wooden façades, on narrow cobblestone streets. The church is perched on top of the village with great views.

Friday

Now we cruise along the upper reaches of the River Yonne to Auxerre, this most beautiful of Burgundian towns whose skyline is punctuated by church spires and its streets lined with timbered 16th century houses. Time for shopping, or photographing the 15th century clock tower. Our last night together on the river is celebrated with a special gourmet dinner of French cuisine.

Saturday

After a leisurely breakfast you will be transported to the airport or your hotel.

01/01/08

Phone: 888.550.8580
Phone: 530.274.0764



Email: info@bargeconnection.com
Website: www.bargeconnection.com

T H E B A R G E

C O N N E C T I O N

SAMPLE ITINERARY

Absoluut 2

NEMOURS TO AUXERRE

2008

Sunday

Pick up at your hotel in Paris at 2pm. Transfer to Absoluut2 moored at Nemours. Champagne reception and introduction to the facilities. Time for a stroll around the village, before your first gourmet dinner on board.

Monday

A drive through the Forest of Fontainebleau brings us to the 16 Century Chateau... home to 34 different sovereigns. We tour the State apartments and Napoleon I's imperial inner apartment. Then cruise on to the beautiful village of Moret-sur-Loing made famous by Impressioniste painter Alfred Siley. You can stroll over the arched bridge and around the town. All the locks are manual and you are invited to participate! It's a lot easier than it looks, and fun.

Tuesday

Today's cruise takes us from the Canal Lateral du Loing to the River Seine and on to the River Yonne for our mooring in Sens. Here we visit the 11th century masterpiece that is St Etienne Cathedral, with time to stroll and or shop.

Wednesday

A morning visit to St. Florentin, on the Burgundy Canal to see goat milk cheese being made and to savour a tasting. An after lunch cruise with more bike riding or a nap on deck to Joigny; a medieval market town with wooden statues on some of the houses. Time to explore or enjoy a game of boules.

Thursday

We continue winding our way up the River Yonne. After lunch we drive to Chablis to taste Grand Cru wines. Then, on to Irancy for some Pinot Noir, continuing to the Cave de Bailly for a sparkling tasting and tour of the statues in the cavernous caves.

Friday

A morning cruise brings us to Auxerre, arguably the most beautiful city in France, for a fantastic walking tour around this ancient town. You will be transported to another time as we walk through the winding streets past the well-preserved half-timber façades. Auxerre features some of the best gothic architecture in Europe with its churches, crypts and abbey, plus the clock tower from the 15th Century. Some of the main streets of the old town have been pedestrianized and provide an 'absoluut' shopper's heaven.

Saturday

After a leisurely breakfast we return you to your hotel of choice or the airport.

01/01/08

Phone: 888.550.8580
Phone: 530.274.0764



Email: info@bargeconnection.com
Website: www.bargeconnection.com

T H E B A R G E

C O N N E C T I O N

SAMPLE ITINERARY

Absoluit 2

PARIS TO EPERNAY

A glorious week of cheese and wine tasting while cruising on the Marne, one of the most beautiful rivers in France.

Sunday

We meet at your hotel and drive to Absoluut2 for a champagne welcome on board, then time to explore Epernay before your first gourmay dinner onboard.

Monday

This morning we cruise through vine-covered hills dotted with small wine villages to the delightful village of Dammary & after Lunch on deck we visit the Abbey of Hautvilliers where the monk Dom Perignon first made champagne, and Reims to see the cathedral, go shopping or down into the cellars of Tattinger, Clicquot or Pomeroy.

Tuesday

Two unexpected sights await in Verzenay: a windmill and a lighthouse. The latter now houses an engaging Wine Museum and also commands a sweeping view over a sea of vines. The Flamboyant-fronted church of Avenay-Val-d'Or and the little town of Ay, which has cultivated the vine since Gallo-Roman times, are both on our morning drive. An afternoon cruise to Chateau Thierry, the scene of American battles in World War I.

Wednesday

Optional visit Hill 204 & Belleau Wood battlefield . Followed by a scenic cruise to La Ferte. With it's delightful riverside walks, and its imposing 17th. C buildings.

Thursday

Today we cruise to Meaux and take a cheese tasting of the famous Brie de Meaux and visit Pomery Mustard de Meaux

Friday

This morning we visit to the magnificent Chateau Vaux-le-Vicomte ,with gardens by " Le Notre" an inspiration for Versailles & set for "the Man in the Iron Mask" before cruising through a tunnel & into the center of Paris, under 30 of her bridges, past Notre Dame, & the Eiffel tour . For our farewell dinner on board. After breakfast, we disembark and transfer you back to your hotel in Paris where your tour ends.

01/01/08

Phone: 888.550.8580
Phone: 530.274.0764



Email: info@bargeconnection.com
Website: www.bargeconnection.com

T H E B A R G E

C O N N E C T I O N

MENU TYPES

Absoluut 2

Continental breakfast

Champagne or Juice

*A selection of freshly baked pastries and breads,
with various butters & preserves*

Cereals, fruit & yogurt

Coffee or tea selection

Lunch

When dining aboard Absoluut2 lunch will be served on deck buffet style, or inside in the dining room depending on your preference

A selection of salads: warm chevre with rocket, salad pomme de terre, salad caprese Quiche Lorraine with warm mediterranean char-grilled vegetables

Charcuterie Platters of quality cold meats and local specialities Traditional French fine herb omelet

Pan-fried foie gras with a prune and eau de vie jus A selection of local cheese

Dessert of the day

Coffee or Tea

Dinner

Entrée (starter)

Salad nicoise - Green bean and potato salad with tuna and anchovies

Gnocchi verts - Handmade potato & Basel pasta with a tomato & herb sauce

Champignon farcee- Stuffed mushrooms Saumon gravadlux mesclun- Salmon carparccio on a bed of mixed salad leaves

Main Course (entrée)

Fillet de boeuf au poivre - The finest French Charolais beefsteak with a merlot and mushroom jus

Noix de St Jacques avec epinard - Sea scallops served on a bed of spinach

Lotte menieure au citron vert- Grilled Monk fish in butter and lime sauce

All dishes served with vegetables fresh from the market daily.

Cheese Board Each night a selection of French cheeses

With a description of the cheese & the region,

Accompanied by specially selected wines.

Desserts

A selection of traditional, all time favorites.

Chocolate mousse

Crème Brulee

01/01/08

Phone: 888.550.8580
Phone: 530.274.0764



Email: info@bargeconnection.com
Website: www.bargeconnection.com

T H E B A R G E

C O N N E C T I O N

CRUISE SCHEDULE

Absoluut 2

2008

2008 DEPARTURE ROUTE

MARCH 31 DUTCH TULIP CRUISE
APRIL 6 DUTCH TULIP CRUISE
APRIL 13 DUTCH TULIP CRUISE
APRIL 20 DUTCH TULIP CRUISE
APRIL 27 DUTCH TULIP CRUISE
MAY 4 DUTCH TULIP CRUISE
MAY 11 DUTCH TULIP CRUISE
MAY 18 DUTCH TULIP CRUISE
MAY 25 (2 WK CRUISE)R'DAM TO PARIS
JUNE 8 PARIS - EPERNAY
JUNE 15 EPERNAY - PARIS
JUNE 22 PARIS - AUXERRE
JUNE 29 AUXERRE - NEMOURS
JULY 6 NEMOURS - AUXERRE
JULY 13 AUXERRE - NEMOURS
JULY 20 NEMOURS - AUXERRE
JULY 27 AUXERRE - NEMOURS
AUGUST 3 NEMOURS T-AUXERRE
AUGUST 10 AUXERRE - NEMOURS
AUGUST 17 NEMOURS - AUXERRE
AUGUST 24 AUXERRE - NEMOURS
AUGUST 31 NEMOURS -AUXERRE
SEPTEMBER 7 AUXERRE - NEMOURS
SEPTEMBER 14 NEMOURS-AUXERRE
SEPTEMBER 21 AUXERRE - NEMOURS
SEPTEMBER 28 NEMOURS - AUXERRE
OCTOBER 5 AUXERRE - PARIS
OCTOBER 12 PARIS - EPERNAY
OCTOBER 19 EPERNAY - PARIS

01/01/08

Phone: 888.550.8580
Phone: 530.274.0764



Email: info@bargeconnection.com
Website: www.bargeconnection.com

T H E B A R G E

C O N N E C T I O N

TERMS & CONDITIONS

Absoloot 2

We welcome children of all ages on Charter bookings and children over 16 on bookings made by the Cabin. Departures are guaranteed with a minimum of 4 passengers. In the event we have less than four passengers we reserve the right to cancel the cruise.

All bookings will be secured upon receipt of a 25% deposit.

The balance of the payment must be received at least 90 days prior to departure.

Cancellation policy

More than 90 days prior to departure, all deposits (25%) will be non-refundable.

90 days or less prior to departure, the entire cost is non-fundable

Trip cancellation insurance is strongly recommended.

YOUR TOUR PRICE INCLUDES:

All accommodation whilst on-board

All meals and beverages, including unlimited wine with meals from our selection, bar drinks and liqueurs from our bar, all normal hot and cold drinks.

Sightseeing trips as determined by the daily schedule including applicable entrance fees.

Use of bicycles.

Transfers between absoloot2 and Hotel Europe in Amsterdam or Sofitel Le Parc in Paris depending on the cruise route or hotel of your choice in Amsterdam or Paris for charter bookings depending on the cruise route.

The tour price includes all planning, handling and operational charges and is quoted at the rate of exchange and tariff effective on signature date. In the event of a material increase (10% to 15%) in foreign currency or in tariff rates, prices may be subject to revision.

NOT INCLUDED IN THE TOUR PRICE:

Air travel and taxes, laundry, personal insurance, excess baggage fees, communication charges, cost of obtaining passport, all items of a personal nature.

Optional Extras:

We are able to arrange special excursions and trips by arrangement such as Hot-air ballooning and golfing.

Gratuities: It is customary to show your appreciation to your crew (normally 5-10%).

01/01/08

Phone: 888.550.8580
Phone: 530.274.0764



Email: info@bargeconnection.com
Website: www.bargeconnection.com

T H E B A R G E

C O N N E C T I O N